

ST 7mmL, Wide Temperature Range
series

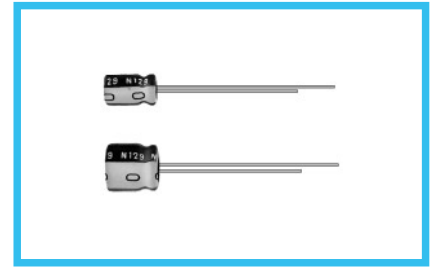

- Wide temperature range of -55 to $+105^{\circ}\text{C}$, with 7mm height.
- Compliant to the RoHS directive (2002/95/EC).

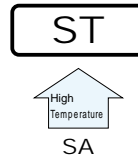

Specifications

Item	Performance Characteristics						
Category Temperature Range	-55 to $+105^{\circ}\text{C}$						
Rated Voltage Range	6.3 to 50V						
Rated Capacitance Range	0.1 to $220\mu\text{F}$						
Capacitance Tolerance	$\pm 20\%$ at 120Hz, 20°C						
Leakage Current	After 2 minutes' application of rated voltage, leakage current is not more than 0.01CV or $3(\mu\text{A})$, whichever is greater.						
Tangent of loss angle ($\tan \delta$)	Measurement frequency : 120Hz, Temperature : 20°C						
	Rated voltage (V)	6.3	10	16	25	35	50
	$\tan \delta$ (MAX.)	0.24	0.21	0.18	0.15	0.13	0.12
Stability at Low Temperature	Measurement frequency : 120 Hz						
	Rated voltage (V)	6.3	10	16	25	35	50
	Impedance ratio $Z_{-25^{\circ}\text{C}} / Z_{+20^{\circ}\text{C}}$	3	2	2	2	2	2
	$Z_T / Z_{20} \text{ (MAX.)}$	6	5	4	3	3	3
Endurance	The specifications listed at right shall be met when the capacitors are restored to 20°C after the rated voltage is applied for 1000 hours at 105°C .						
Shelf Life	After storing the capacitors under no load at 105°C for 1000 hours and then performing voltage treatment based on JIS C 5101-4 clause 4.1 at 20°C , they shall meet the specified values for the endurance characteristics listed above.						
Marking	Printed with white color letter on black sleeve.						

Radial Lead Type

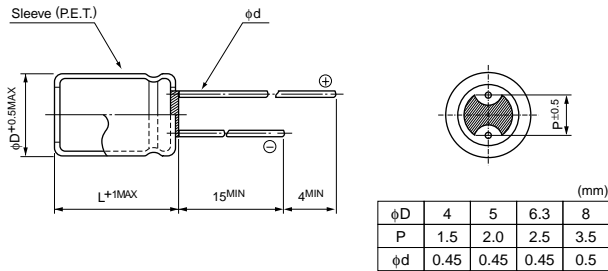

Type numbering system (Example : 10V 33 μF)

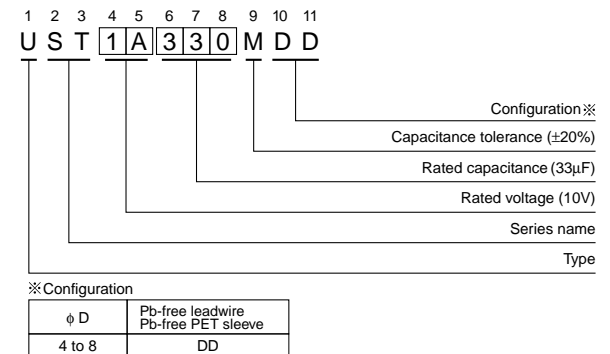

Dimensions

Cap. (μF)	V	6.3	10	16	25	35	50
Code		0J	1A	1C	1E	1V	1H
0.1	0R1						4×7 1.0
0.22	R22						4×7 2.3
0.33	R33						4×7 3.5
0.47	R47						4×7 5.0
1	010						4×7 10
2.2	2R2						4×7 19
3.3	3R3						4×7 24
4.7	4R7					4×7 24	5×7 29
10	100			4×7 29	5×7 33	5×7 36	6.3×7 44
22	220	4×7 34	5×7 38	5×7 44	6.3×7 51	6.3×7 57	8×7 65
33	330	5×7 42	5×7 47	6.3×7 57	6.3×7 63	8×7 72	
47	470	5×7 50	6.3×7 59	6.3×7 68	8×7 78		
100	101	6.3×7 77	8×7 96	8×7 107			
220	221	8×7 130	8×7 140				Case size $\phi D \times L$ (mm)

Rated ripple current 120Hz

Frequency coefficient of rated ripple current

Frequency	50 Hz	120 Hz	300 Hz	1 kHz	10 kHz or more
Coefficient	0.70	1.00	1.17	1.36	1.50

Please refer to page 20, 21, 22 about the formed or taped product spec.
Please refer to page 4 for the minimum order quantity.

CAT.8100Z