

## 1 Scope

The present specifications shall apply to a RU4C.

## 2 Outline

Type	Silicon Diode (Mesa Type)
Structure	Resin Molded Flammability:UL94-V0(Equivalent)
Applications	Pulse Rectification, etc.

## 3 Absolute maximum ratings

No.	Item	Symbol	Unit	Rating	Conditions	
1	Transient Peak Reverse Voltage	V <sub>RSM</sub>	V	1050		
2	Peak Reverse Voltage	V <sub>RM</sub>	V	1000		
3	Average Forward Current	I <sub>F (AV)</sub>	A	1.5 (Ta=40°C)	With out Fin	Refer to 6
				2.5 (Ta=60°C)	With Fin	
4	Peak Surge Forward Current	I <sub>FSM</sub>	A	50	10msec. Half sinewave, one shot	
5	Junction Temperature	T <sub>j</sub>	°C	-40 ~ +150		
6	Storage Temperature	T <sub>stg</sub>	°C	-40 ~ +150		

## 4 Electrical characteristics (Ta=25°C, unless otherwise specified)

No.	Item	Symbol	Unit	Value	Conditions
1	Forward Voltage Drop	$V_F$	V	1.60 max.	$I_F=3.0A$
2	Reverse Leakage Current	$I_R$	μA	50 max.	$V_R=V_{RM}$
3	Reverse Leakage Current Under High Temperature	$H \cdot I_R$	μA	500 max.	$V_R=V_{RM}$ , $T_j=100^\circ C$
4	Reverse Recovery Time	Trr-1	μs	0.4 max.	$I_F=I_{RP}=0.1A$ , Ta=25°C 90% Recovery point
		Trr-2	μs	0.18 max.	$I_F=0.1A$ , $I_{RP}=0.2A$ , Ta=25°C 75% Recovery point
5	Thermal Resistance	$R_{th(j-l)}$	°C/W	8 max.	Between Junction and Lead

5  $V_F$  test and test circuit

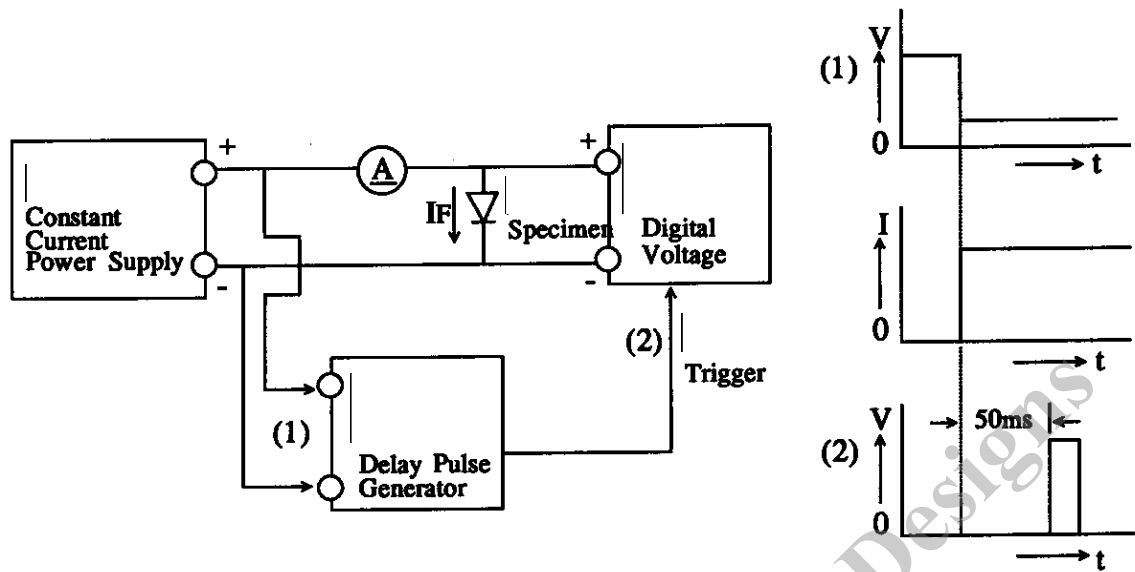

6 Derating

Derating to the ambient temperature.  
Power loss generated by voltage is not taken into consideration.

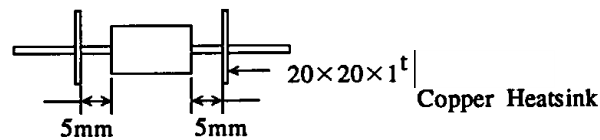
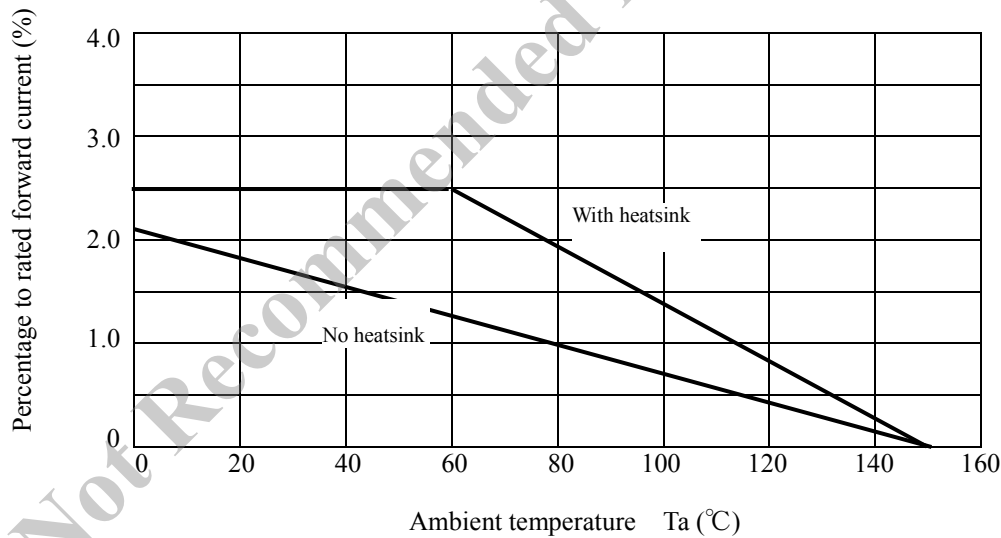

7 Package information

7-1 Package type, physical dimensions and material

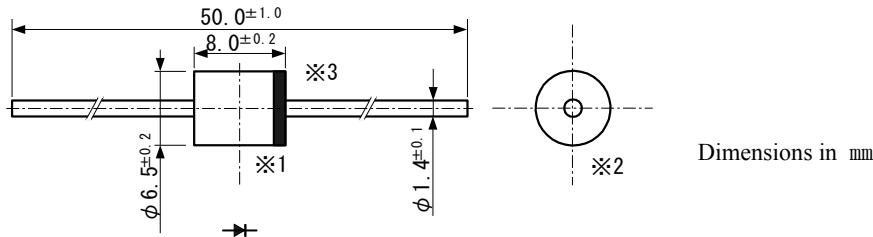

- ※1 Wire diameter of lead tips is  $\phi$  1.55mm(max.)
- ※2 The allowance position of body against the center of whole lead wire is 0.5mm (max.)
- ※3 The centric allowance of lead wire against center of physical body is 0.3mm (max.)
- ※4 The burr may exit up to 2mm from the body of lead

7-2 Appearance

The body shall be clean and shall not bear any stain, rust or flaw.

7-3 Marking

① Type number RU4C

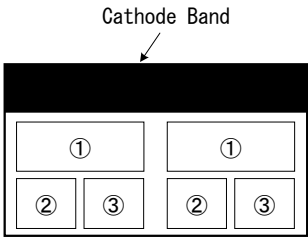

- ② Lot number 1
  - First digit : Last digit of year
  - Second digit : Month
  - From 1 to 9 for Jan. to Sep.
  - O for Oct., N for Nov., and D for Dec.
- ③ Lot number 2 (ten days)
  - : Top of the month
  - : Middle of month
  - : End of month

The Type number and Lot number are to be marked in red.