

IMPORTADOR

Comercializadora Thomson de Mexico, S.A. de C.V.
 Miguel de Cervantes Saavedra No. 57
 Col. Ampliación Granada
 C.P. 11529 Mexico D.F.
 Telefono: (55)25 81 53 20
 RFC: CTM-980723-KS5

0151

EXPORTER

Thomson multimedia Inc.
 10330 N. Meridian St. Indianapolis, IN 46290
 © 2002 Thomson multimedia Inc.
 Trademark(s) ® Registered
 Marca(s) Registrada(s)
 Marque(s) ® Déposée(s)
 55274770 (EN/F/E)
www.rca.com
www.rca.com/LatinAmerica
 Made in China/Fabricado en China

RCA

u
s
e
r
m
a
n
u
a
l

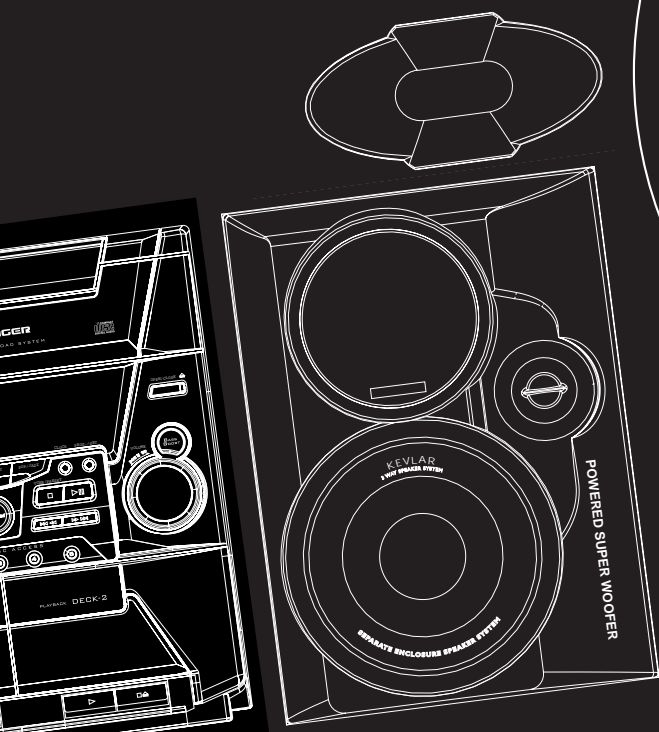

RS2606

www.DataSheet4U.com

RS2604

RS2606

It is important to read this instruction book prior to using your new product for the first time.
Es importante leer este manual antes de usar por vez primera su equipo.

FCC Information

EN

This device complies with Part 15 of the FCC Rules. Operation is subject to the following two conditions: (1) This device may not cause harmful interference, and (2) this device must accept any interference received, including interference that may cause undesired operation.

In accordance with FCC requirements, changes or modifications not expressly approved by Thomson multimedia Inc. could void the user's authority to operate this product.

This device generates and uses radio frequency (RF) energy, and if not installed and used properly, this equipment may cause interference to radio and television reception.

If this equipment does cause interference to radio or television reception (which you can determine by unplugging the unit), try to correct the interference by one or more of the following measures:

- Re-orient the receiving antenna (that is, the antenna for the radio or television that is "receiving" the interference).
- Move the unit away from the equipment that is receiving interference.
- Plug the unit into a different wall outlet so that the unit and the equipment receiving interference are on different branch circuits.

If these measures do not eliminate the interference, please consult your dealer or an experienced radio/television techni-

cian for additional suggestions. Also, the Federal Communications Commission has prepared a helpful booklet, "How To Identify and Resolve Radio TV Interference Problems." This booklet is available from the U.S. Government Printing Office, Washington, DC 20402. Please specify stock number 004-000-00345-4 when ordering copies.

This product complies with DHHS Rules 21 CFR Subchapter J. Applicable at the date of manufacture.

For Your Safety

The AC power plug is polarized (one blade is wider than the other) and only fits into AC power outlets one way. If the plug won't go into the outlet completely, turn the plug over and try to insert it the other way. If it still won't fit, contact a qualified electrician to change the outlet, or use a different one. Do not attempt to bypass this safety feature.

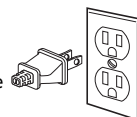



CAUTION: TO PREVENT ELECTRIC SHOCK, MATCH WIDE BLADE OF PLUG TO WIDE SLOT, FULLY INSERT.

Have a Blast- Just Not in Your Eardrums

Make sure you turn down the volume on the unit before you put on headphones. Increase the volume to the desired level only after headphones are in place.



 <p>THE LIGHTNING FLASH AND ARROW-HEAD WITHIN THE TRIANGLE IS A WARNING SIGN ALERTING YOU OF "DANGEROUS VOLTAGE" INSIDE THE PRODUCT.</p>	<p>CAUTION RISK OF ELECTRIC SHOCK DO NOT OPEN</p> <p>CAUTION: TO REDUCE THE RISK OF ELECTRIC SHOCK, DO NOT REMOVE COVER (OR BACK). NO USER-SERVICEABLE PARTS INSIDE. REFER SERVICING TO QUALIFIED SERVICE PERSONNEL.</p>	 <p>THE EXCLAMATION POINT WITHIN THE TRIANGLE IS A WARNING SIGN ALERTING YOU OF IMPORTANT INSTRUCTIONS ACCOMPANYING THE PRODUCT.</p>
<p>SEE MARKING ON BOTTOM / BACK OF PRODUCT</p>		

WARNING: TO PREVENT FIRE OR ELECTRICAL SHOCK HAZARD, DO NOT EXPOSE THIS PRODUCT TO RAIN OR MOISTURE.

For Your Records

In the event that service should be required, you may need both the model number and the serial number. In the space below, record the date and place of purchase, and the serial number:

Model No.
Remote Control No.
Date of Purchase
Place of Purchase
Serial No.

Service Information

This product should be serviced only by those specially trained

in appropriate servicing techniques. For instructions on how to obtain service, refer to the warranty included in this Guide.

Technical specification

Power Supply: 120V~60Hz
Power consumption: 300 Watts

IMPORTER
Comercializadora Thomson de Mexico, S.A. de C.V.
Miguel de Cervantes Saavedra No. 57
Col. Ampliación Granada
C.P. 11529 Mexico D.F.
Telefono: (55)25 81 53 20
RFC: CTM-980723-KS5

Contents

FCC/ Safety Information

Installation2

Controls & Indicators

- Main Unit3
- Tape Player3
- Remote Control4

Display

- Showing the Demonstration5
- Display Timer/Clock5
- Setting the Time5
- Setting the Timer5
- Activating the Timer5
- Adjusting the Display5
- Brightness5
- Sleep Mode5

Sound Features

- Using Preset Equalizer Curves6
- Creating a Custom Curve6

-6
- Sub-Woofer6
- Muting Audio6
- X-Surround6

CD Player

- Loading Discs6
- Playing Discs6
- Shuffling the Play Order6
- Sampling Tracks6
- Repeating the Play Order7
- Setting Up a CD program7
- Playing a Program List7
- Displaying the Program list7
- Deleting a Program List7
- Skipping a Disc7
- Searching through a CD7

Tuner

- Tuning to a Station8
- Using Presets8
- Auto Preset Program (for FM only)8
- Setting Presets8

- Suppressing Stereo Signal8

Tape Player

- Playing a Tape9
- Continuous Play9
- Recording9
- From Tuner9
- From CD9
- Tape to Tape9
- From an Auxiliary Input9

Troubleshooting Tips10

Maintenance

- Cleaning10
- CD Player10
- Tape Player10

More Information11

Limited Warranty13

Installation

EN

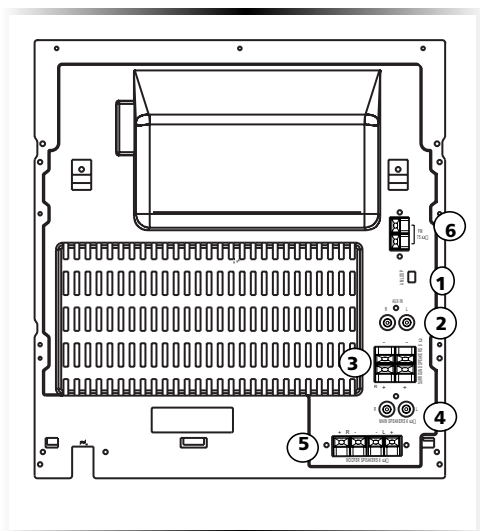

1. AM Loop Antenna Connector
2. Auxiliary Connector
3. Surround Speaker Jacks
4. Main Speaker Jacks
5. Subwoofer Speaker Jacks
6. FM Antenna Jack

Unpacking the system:

You should have:

- one main unit (with 2 speakers);
- surround speakers (RS2606 only)
- one remote control;
- one AM loop antenna;
- T-Type FM antenna wire;
- one user's guide;
- one safety leaflet.

To ensure sufficient ventilation, keep the spacings shown below free from other surfaces:

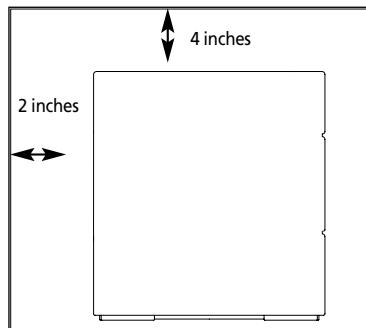
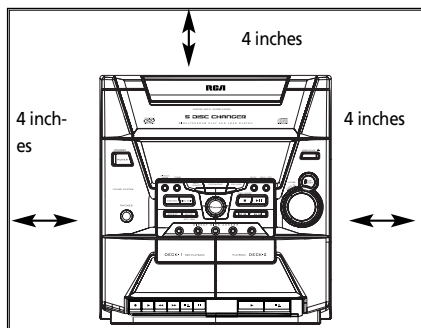

Antenna and Speaker Wire Connection

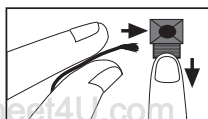

Push terminal tab down to insert wire.

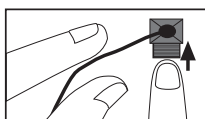

Release tab to lock wire in the terminal.

NOTE: Make sure the insulation is completely removed from the ends of the Antenna and speaker wires at all connection points.

Controls and Indicators

EN

Main Unit

OPEN/CLOSE — Opens or closes the disc tray.

DISC 1 - DISC 5 — Selects disc 1, 2, 3, 4, or 5

DISC SKIP — Skips to the next CD in the tray

STANDBY/POWER — Turns power on or off (STANDBY mode).

PHONES — Jack for connecting headphones

SOURCE — Selects the CD player/ tuner/ tape player/ external source

DIMMER/DEMO — Turns the feature demonstration on or off, adjusts display brightness.



STOP / TUNE / PRESET — Stops CD track, sets tune or preset mode



SKIP FORWARD —

Increments radio frequency, CD tracks or setting options.



SKIP BACKWARD —

Decrements radio frequency, CD tracks or setting options



PLAY/PAUSE — Plays or pauses CD

CLOCK — Shows clock time and enters clock setting mode.

TIMER — Enters timer setting mode and turns the mode on/off.

BAND/AUTO PROG. — Changes between FM and AM tuner bands. Enters auto preset program in FM mode.

REPEAT - Selects among repeat modes.

PROG./SET- enters program or setting mode for CD & tuner mode.

BASS BOOST — Turns sub-woofer on or off

ROCK/CLASSIC, CUSTOM/FLAT, POP/JAZZ — selects among the different EQ modes.

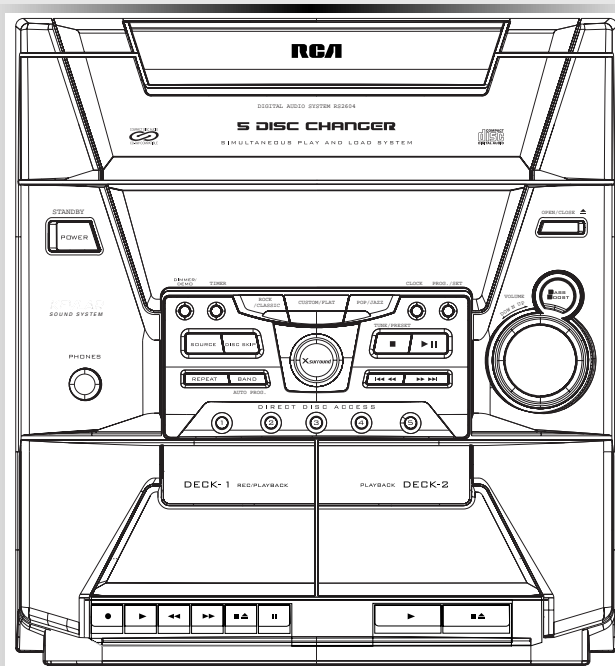

X-SURROUND — Press once to activate X-SURROUND

VOLUME — Increases/ decreases volume.

Tape Player

- RECORD
- ▶ PLAY
- ◀◀ REWIND
- ▶▶ FAST-FORWARD
- STOP/EJECT
- || PAUSE



Tip: In **STANDBY** mode (press **POWER** off), the system displays the time. Press **POWER** to turn the system on in the previously used mode. Press **CD**, **TAPE**, **TUNER**, or **AUX (Remote Only)** to select the corresponding mode. Look at the display icons to identify the current mode.

Controls and Indicators

EN

Remote Control

POWER — Turns power on or off (**STANDBY** mode).

TUNER — Selects tuner

CD — Selects CD player

TAPE — Selects tape player

AUX — Selects external input.

B-BOOST - Turns B BOOST on or off

VOL+ or VOL- — Increases/ decreases volume

EQ — Selects equalizer presets

PLAY/PAUSE ►|| — Plays or pauses current CD

STOP — Stops playing CD

NEXT/FWD ►► — Increments CD track; searches through CD

PREV/REV ◄◄ — Decrements CD track; searches through CD
(Press **NEXT/FWD** or **PREV/REV** to tune up/ down tuner frequency)

DISC SKIP — Skips to next CD

REPEAT — Repeats a track, CD, or all CDs.

MUTE - mutes sound

SHUFFLE — Turns on/off random listening

FM ST. - Toggles between FM stereo and mono

INTRO - Turns INTRO mode on or off to play the first 10 seconds of each track.

PRESET UP/DOWN — Selects next/ previous preset station

OPEN/CLOSE — opens/closes cd tray door

SLEEP - selects the time interval in minutes before the unit turns off

X-SURROUND - enables/disables X-surround feature

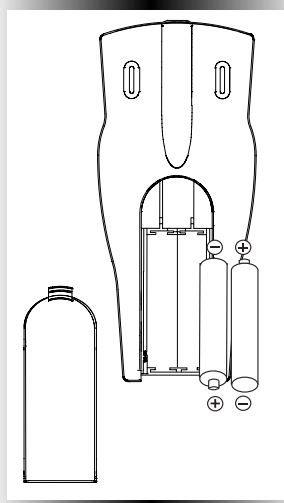
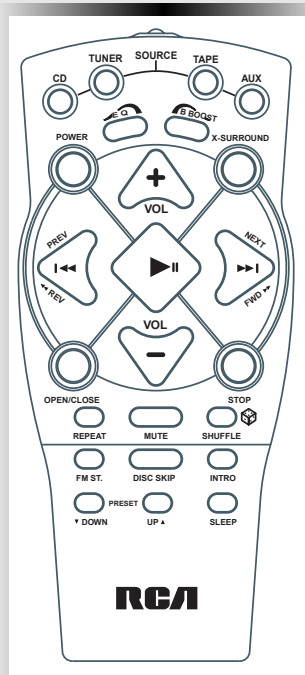

Battery Size:
"AAA" or "UM-4" or "R03"

www.DataSheet4U.com



Showing the Demonstration

Not operational in CD mode. Press **DIMMER/DEMO** to turn on/off demonstration mode. The demonstration scrolls through all display operations.

DISPLAY TIMER/CLOCK

Setting the Time

1. Press and hold **CLOCK** until the hour flashes on the display.
2. Press **SKIP BACKWARD** or **SKIP FORWARD** to set the hour and then press **CLOCK** to shift to minute digits.
3. Press **SKIP BACKWARD** or **SKIP FORWARD** to set the minute.
4. Press **SET** to save settings and **STOP** to quit setting.

Note: When system is ON, you can press **CLOCK** to display the current time for about 2 seconds.

Setting the Timer

1. Press and hold **TIMER** until the **ON** appear with the hour flashing (**ON** - timer on time)
2. For setting time, press **SKIP FORWARD** / **BACKWARD** to set the hour and then press **TIMER** to shift to minute digits.
3. Press **SKIP FORWARD** / **BACKWARD** to set the minute.
4. Press **TIMER** to change to **OF** (timer off time) with hour flashing. Repeat steps 2 & 3 for timer off time setting.
5. Press **TIMER** to select source. Press **SKIP FORWARD** / **BACKWARD** to select between CD /TUNER / TAPE)
6. Press **TIMER** to set volume. Rotate the VOLUME knob to set desired volume level.
7. Press **SET** to save settings or **STOP** to quit setting.

Activating the Timer

Press and release **TIMER** to turn on/off the alarm. The alarm is active when the clock icon indicator is lit.



Adjusting the Display Brightness

1. Press and hold **DIMMER/DEMO** for more than 2 seconds.
2. While the dimmer is displayed, press and release **DIMMER/DEMO** to select the desired level (**DIM 0 - 3**).

Sleep Mode

You can select the time interval in minutes before the unit turns off automatically. Press **SLEEP** on the remote to select among 120, 90, 60, 45, 30, 15 & 5 minutes. (Remote Only)

Sound Features

EN Using Preset Equalizer Curves

Press **ROCK/CLASSIC**, **CUSTOM/FLAT**, **POP/JAZZ** on the main unit or **EQ** on the remote to toggle among **FLAT**, **ROCK**, **JAZZ**, **POP**, **CLASSICAL** & **CUSTOM**. The display shows briefly the selection.

Creating a Custom Curve

1. Press **CUSTOM/FLAT** to select **CUSTOM** mode.
2. While "**CUSTOM**" is displayed, press **SKIP FORWARD** **▶▶▶▶** / **BACKWARD** **◀◀◀◀** to cycle among displayed bass-, mid-, and treble - range levels.

TRE+08

3. While **BAS** or **TRE** is displayed, adjust **VOLUME** to set the associated gain between -10 - +10.

Boosting the bass

Press **Bass Boost** to turn on/off boosting the bass frequency.

Muting Audio

Press **MUTE** on the remote to cut the sound. (Remote Only)

MUTE

X-Surround

Press **X-SURROUND** to enjoy enriched sound quality. This feature gives you:

1. Better width and depth for vocal and instrumental sound.
2. More powerful presence for studio recording.
3. Enhanced surround effects with greater flexibility in positioning speakers.

CD PLAYER



Loading Discs

1. Press **SOURCE** repeatedly to select **CD** mode.
2. Press **OPEN/CLOSE** to open the drawer.
3. Insert up to five discs with label face up. (Press **DISC SKIP** to rotate the disc carrier.)
4. Press **OPEN/CLOSE** to close the drawer. Loaded disc position icon lights.

Playing Discs

Press **PLAY/PAUSE** to begin or pause play, and **STOP** to stop play.

Select a specific disc by pressing **DISC 1 - DISC 5**.

Press **SKIP FORWARD** **▶▶▶▶** / **BACKWARD**

◀◀◀◀ to select a specific track.

Play and load simultaneously by:

1. Press **OPEN/CLOSE** to open the tray while a CD is playing
2. Load/change discs for available trays by pressing **DISC SKIP**.
3. Press **OPEN/CLOSE** to close the tray.

Shuffling the Play Order

Press **SHUFFLE** to turn on/off the playing of tracks in random order. (Remote Only)

Sampling Tracks

Press **INTRO** to play the first 10 seconds of each track on the current disc, all discs in the tray, or turn **INTRO** mode off. (Remote Only)

(Note: You may also press **REPEAT** to select 1 disc or all discs before activating **INTRO** & **SHUFFLE** functions)



Tip: While playing a CD, press and hold **SKIP-FORWARD** or **BACKWARD** for more than 2 seconds to search through the CD.

Repeating the Play Order

Press **REPEAT** to repeat the current track, current disc, all discs, or turn **REPEAT** mode off.

Setting Up a CD Program

You can program the CD player to play up to any 32 tracks on the CDs in the tray.

1. While the CD player is stopped, press **PROG./SET** to enter program mode. The system displays the next available program number: "--P:01," with "--" flashing, prompts you for the first track in the program list.

2. Press **SKIP FORWARD** / **BACKWARD** to select a track (press **DISC SKIP** or **DISK 1** - **DISK 5** to select a track from a different disc).
3. Immediately press **SET** to assign the selected track to the program number. After 3 seconds, you are prompted for the next track in the program list. (In CD program mode, **PROG** icon will be lit.)



Playing a Program List

While in **PROGRAM** mode, press **PLAY**.

Displaying the Program List

1. While the CD player is stopped, press **SET** to enter **PROGRAM** mode.
2. Press **SET** repeatedly to list each track assignment in the program list.

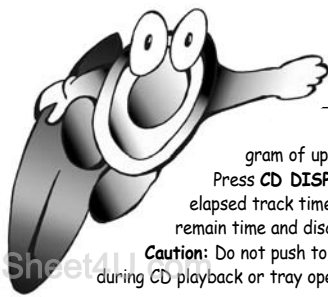

Tips: You can create a program of up to 32 tracks.

Press **CD DISPLAY** repeatedly to view elapsed track time, track number, track remain time and disc remain time.

Caution: Do not push to force closing of the tray during CD playback or tray opening.

Deleting Program List

While in **PROGRAM** mode, press and hold **STOP** for 5 seconds. The system displays the message **CLEAR**.

Skipping a Disc

Press **DISC SKIP**.

Searching Through a CD

Press and hold **SKIP FORWARD** / **BACKWARD** **◀◀ ▶▶** to search through a CD as it is playing.