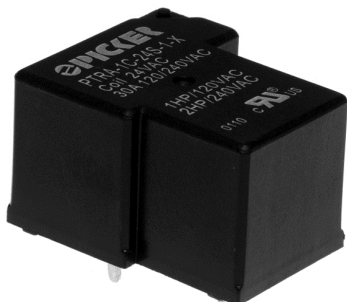

50 Amp Power PCB Relay

PTRE

FEATURES

- Most Popular Power PCB Relay Footprint - T90
- 50 Amp 240 VAC General Purpose UL Rating
- 2 HP 250 VAC Rating
- UL Class F Insulation Standard
- Meets UL 508 and UL 873 Spacing with Pin 6 Omitted
- Epoxy Sealed, Immersion Cleanable
- RoHS Compliant

FACTORY RATINGS

Load Type	Voltage	1 Form A (SPST-NO)	1 Form B (SPST-NC)	1 Form C (SPDT)	
				NO	NC
Resistive 6,000 Cycles	240 VAC 30 VDC	50 A	35 A	50 A	35 A
Lamp 3,000 Cycles	240 VAC	TV-5	—	TV-5	—
Electric Ballast 6,000 Cycles	280 VAC	5 A	—	5 A	—
Motor Load 3,000 Cycles	250 VAC	2 HP	1.5 HP	2 HP	1.5 HP

CHARACTERISTIC

Operate Time	15 ms Max.
Release Time	10 ms Max
Insulation Resistance	1,000 MΩ min, at 500 VDC
Dielectric Strength	50 Hz 2,500 V 1 Min Between Coil and Contacts
	4,000 V without Pin 6
	50 Hz 1,500 V 1 min. Between Contacts
Shock Resistance	200 m/s ² , 11 ms
Vibration Resistance	10 - 55 Hz Double Amplitude
Terminal Strength	10N
Power Consumption	1.5 W

ORDERING INFORMATION

Example:	PTRE	-1C	-12	S	T	F	-X
Model:	PTRE						
Contact Form:	1A or 1C						
Coil Voltage:	3, 5, 6, 9, 12, 15, 18, 24, 48, 110						
Configuration:	Nil: Open Frame; S: Sealed; C: Covered E: Epoxy Sealed not Water Washable						
Contact Material:	T: AgSnO ₂						
Insulation Material:	F: UL Class F						
Spacing:	Nil: UL 508; -1: UL 508 and 873 (Pin # 6 omitted)						
ROHS Compliant:	-X						

Box Quantity: 600; Inner Box 300

COIL DATA

Coil Voltage		Resistance (Ohms $\pm 10\%$)	Must Operate Voltage Max (VDC)	Must Release Voltage Min. (VDC)	Coil Power (W)
Rated	Max				
3	3.9	6.0	2.25	0.3	1.5
5	6.5	16.7	3.75	0.5	
6	7.8	24.0	4.50	0.6	
9	11.7	54.0	6.75	0.9	
12	15.6	96.0	9.00	1.2	
15	19.5	150	10.25	1.5	
18	23.4	216	13.50	1.8	
24	31.2	384	18.00	2.4	
48	62.4	1,536	36.00	4.8	
110	143	8,067	82.50	11.0	

NOTES:

The use of any coil voltage less than the rated voltage will compromise the operation of the relays. Must Operate Voltage is listed for test purposes only and is not to be used as design criteria. Pickup and release voltages are for test purposes only and are not to be used as design criteria.

Dimensions are in mm, Inches are listed for reference only.

DIMENSIONS (mm/inches)

Knock off, on top corner, nib for ventilation after soldering and water wash.

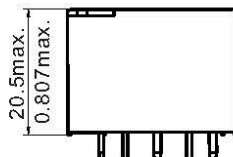
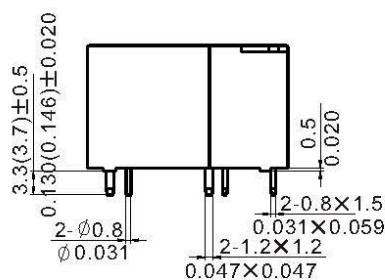
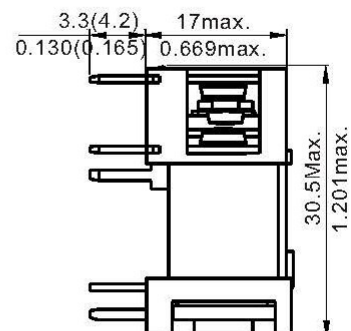
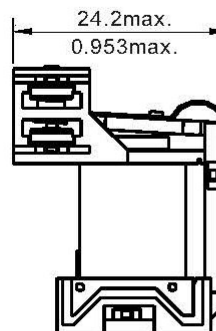
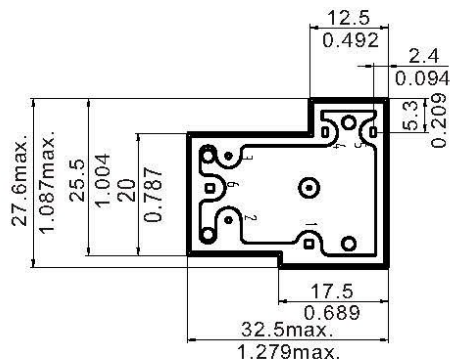

Open type

-1 Pin 6 Omitted

With Pin 6

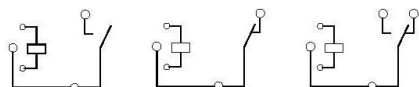

Wiring diagram(Bottom view)

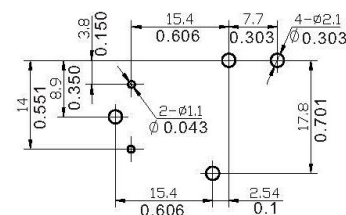
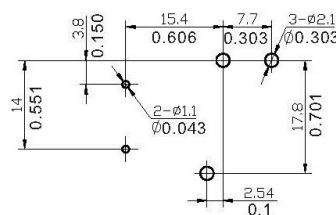

Mounting (Bottom view)



3220 Commander Drive, Suite 102 Carrollton, TX 75006

Sales: (972) 713-6272

(888) 997-3933

Fax: (972) 735-0964

www.PickerComponents.com

e-mail: sales@pickercomponents.com