

## HIGH VOLTAGE DC LATCH RELAY

## LDC-350



## ▶ 코일정격 (Magnet coil ratings)

Nominal voltage(V)	Item	Inrush Coil current (Max.)	Pick-up Holding Time (ms)	Pick-up voltage (V)	Drop-out voltage (V)	Drop-out Time (ms)	Max. voltage (V)max.
12		2.5A	50~100ms	9.0VDC	9.0VDC	50~100ms	15VDC
24		1.5A	50~100ms	18.0VDC	18.0VDC	50~100ms	30VDC

Notes : 1. Nominal current and coil resistance are measured at +20°C.  
 2. Differences of coil resistance are  $\pm 10\%$ .  
 3. Performance characteristic coil temperature is measured at +20°C.

## ▶ 접점정격 (Contact ratings)

(450VDC기준)

Item	Type	1Pole Resistive load ( $L/R \leq 1\text{ms}$ )
		LDC 350
Max. Continuous current (wire size 100mm <sup>2</sup> ×2)		350A
Max. switching current		350A
Max. switching voltages		900VDC
Contact rating switching voltages		350VDC
Voltage drop across contacts per 100A		30mV max.
Min. permissible load		12VDC 0.5A
Description		S.P On/Off (a)
Contact Arrangement, auxiliary contacts		1Form A (SPST-NO.)
Aux. Contact Current, Max.		2A 30VDC / 3A 125VAC
Aux. Contact Current, Min.		100mA 8VDC

## ▶ 주문방법 (Ordering information)

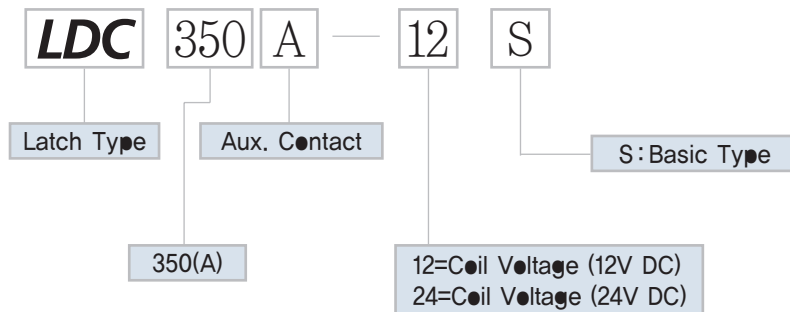

## HIGH VOLTAGE DC LATCH RELAY

# LDC-350



LDC350

### ▶ 성능 (Characteristics)

Expected life	Mechanical (Min.)		10 <sup>6</sup>
	Electric (L/R≤1ms)	300V DC 350A	10 <sup>3</sup>
		250V DC 400A	10 <sup>5</sup>
Initial insulation resistance			Min. 100M $\Omega$ 500V DC
Initial breakdown voltage	Between open contacts		3500V AC 1Min. 5mA
	Between contacts & coil		3500V AC 1Min. 5mA
Operate time (at 20℃)			Max. 15ms
Release time (at 20℃)			Max. 8ms
Shock resistance	Functional		Min 490 % {50G}
	Destructive		Min 147 % {15G}
Vibration resistance	Functional		100 % {10G} 10 to 500Hz
	Destructive		100 % {10G} 10 to 500Hz
Conditions for operation transport and storage	Ambient temperature		-40℃ to +85℃
	Humidity		5 to 85% R.H.
Unit weight			610g

### ▶ 특성곡선 (Reference data)

#### ● 온도상승곡선

- 통전시간의 최대치 Max, Current capacity  
Max, Continuous thermal current rating (amperes)

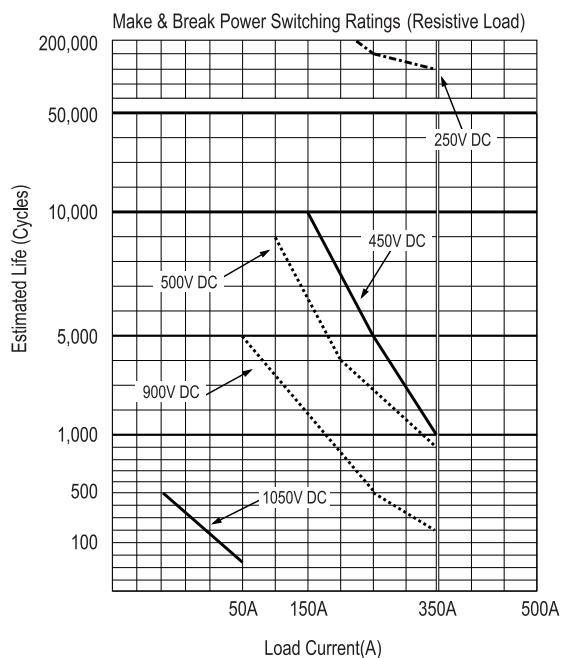
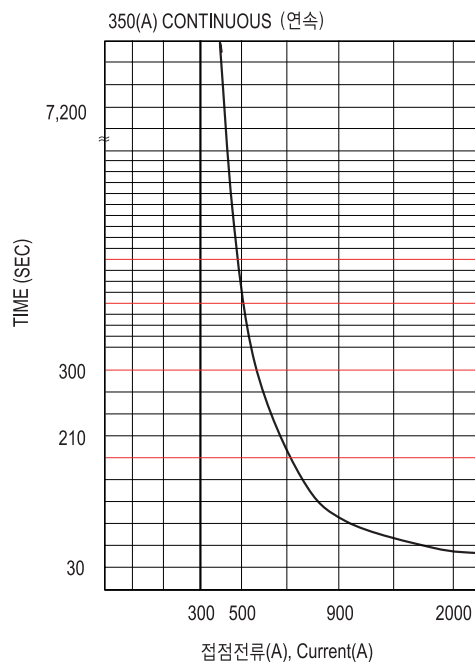

## HIGH VOLTAGE DC LATCH RELAY

## LDC-350



▶ 외형치수도 (Dimension in mm)

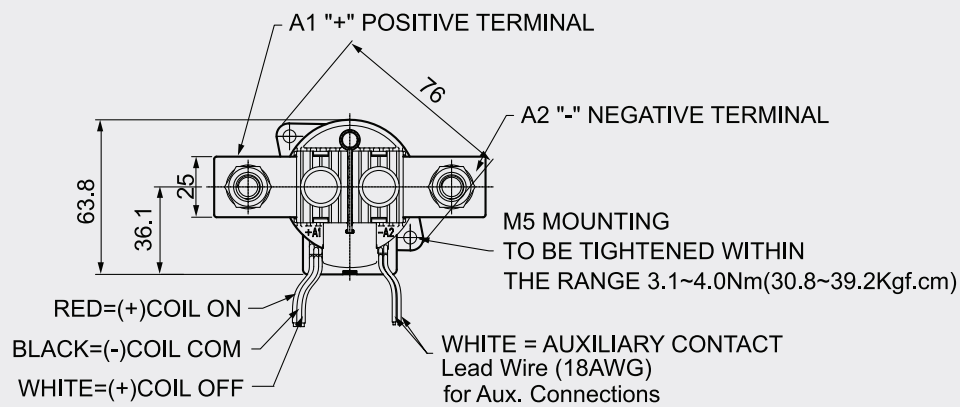

Lead Wire (18AWG)  
for Coil Connections

Mounting Dimensions

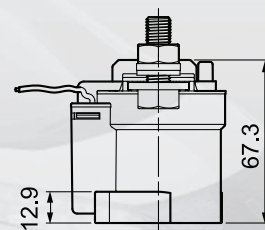
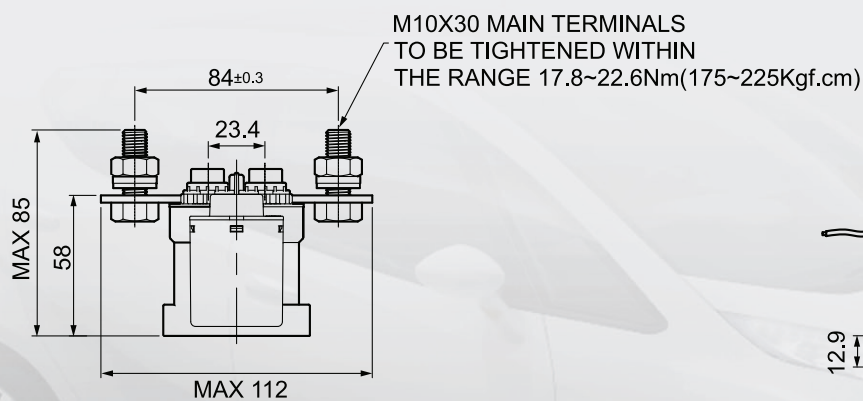
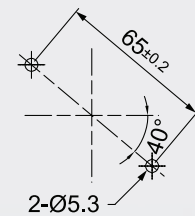

# HIGH VOLTAGE DC LATCH RELAY

## LDC-350



LDC350

### ▶ LDC350-2P 결선도

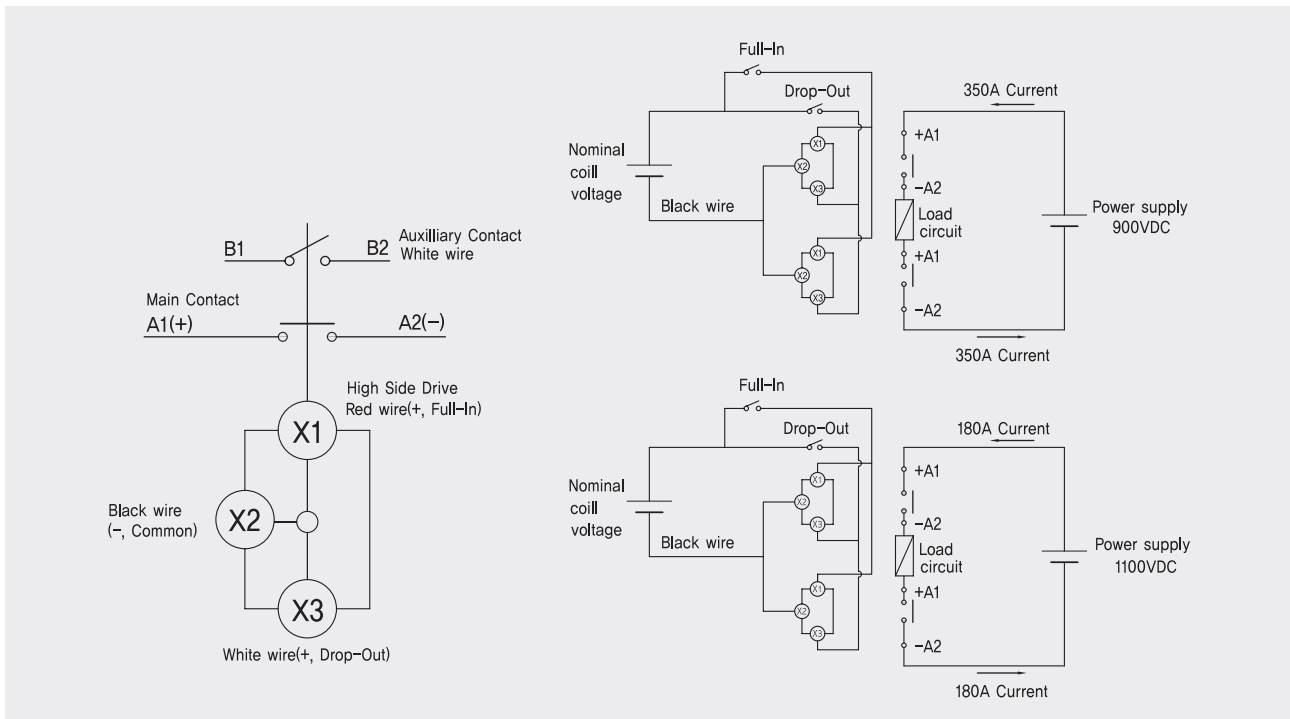

### ▶ LDC350-2P 외형치수도 (Dimension in mm)

