

Features

- * $I_o = 3.0A$
- * $V_{RRM}: 50V \sim 1000V$
- * Glass passivated chip
- * High surge forward current capability

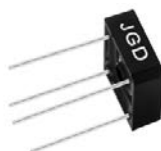

RoHS
COMPLIANT

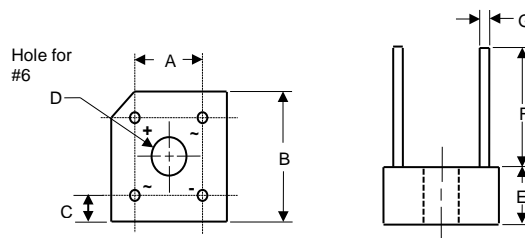

KBPC3				
DIM	INCHES		MM	
	MIN	MAX	MIN	MAX
A	0.405	0.445	10.3	11.3
B	0.578	0.618	14.70	15.70
C	0.067	0.107	1.70	2.70
D	0.142	0.158	3.60	4.00
E	0.224	0.264	5.70	6.70
F	0.590	---	15.0	---
G	0.030 DIA. TYP		0.76 DIA. TYP	

Applications

- * General purpose 1 phase Bridge rectifier applications

Absolute Maximum Ratings ($T_A=25^\circ C$ unless otherwise noted)

Item	Symbol	Unit	Conditions	KBPC3					
				005	01	02	04	06	08 10
Repetitive Peak Reverse Voltage	V_{RRM}	V		50	100	200	400	600	800 1000
Average Rectified Output Current	I_o	A	60HZ sine wave, R- load, $T_a=40^\circ C$	3.0					
Surge(Non-repetitive) Forward Current	I_{FSM}	A	60Hz sine wave, 1 cycle, $T_a=25^\circ C$	60					
Current Squared Time	I^2t	A^2S	$1ms \leq t < 8.3ms$ $T_j=25^\circ C$, Rating of per diode	15					
Storage Temperature	T_{stg}	$^\circ C$		-55 ~+150					
Junction Temperature	T_j	$^\circ C$		-55 ~+150					

Electrical Characteristics ($T_A=25^\circ C$ unless otherwise noted)

Item	Symbol	Unit	Test Condition	Max
Peak Forward Voltage	V_{FM}	V	$I_{FM}=1.5A$, Pulse measurement, Rating of per diode	1.1
Peak Reverse Current	I_{RRM}	μA	$V_{RM}=V_{RRM}$, Pulse measurement, Rating of per diode	10
Thermal Resistance	$R_{\theta J-A}$	$^\circ C/W$	Between junction and ambient	18

Ratings and Characteristic Curves

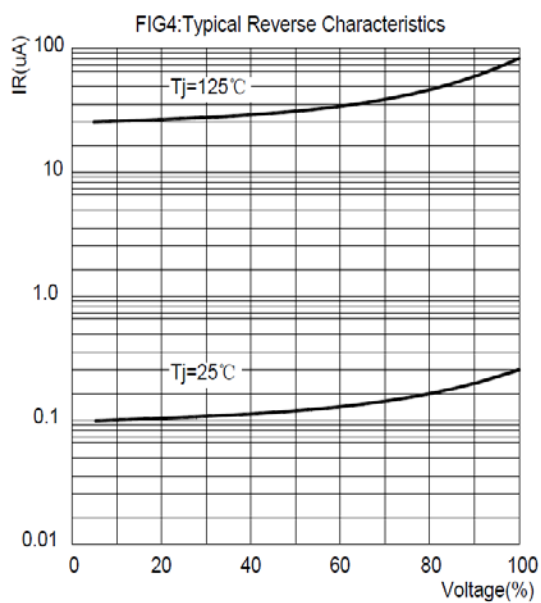
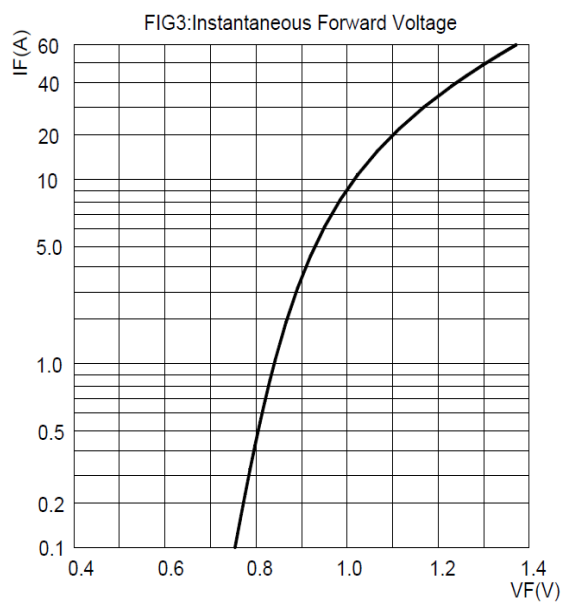
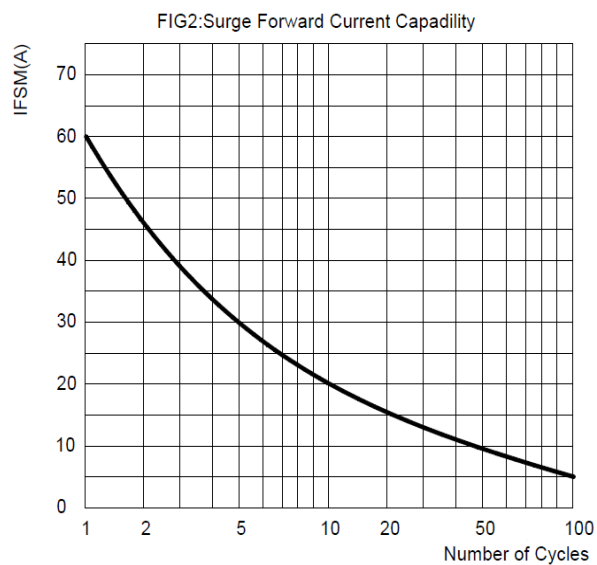
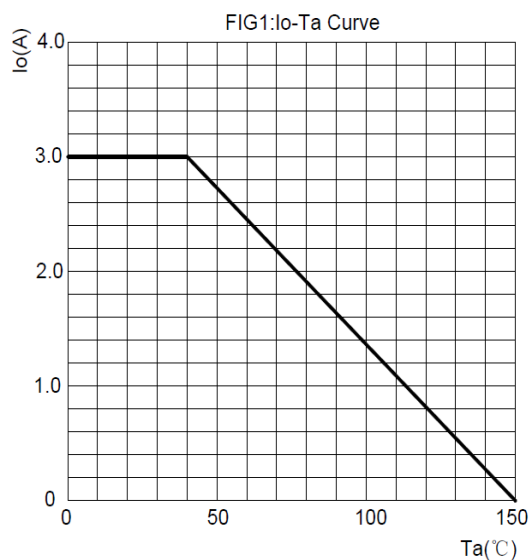



KBPC3005 THRU KBPC310

Bridge Rectifiers

Ordering Information

Part No.	Package	Packing Code	Packing
KBPC3005 THRU KBPC310	KBPC3	B02	200pcs/Bulk

Disclaimer

Specifications of the products displayed herein are subject to change without notice. JGD or anyone on its behalf, assumes no responsibility or liability for any errors in accuracies.

Information contained herein is intended to provide a product description only. No license, express or implied, to any intellectual property rights is granted by this document. Except as provided in JGD's terms and conditions of sale for such products, JGD assumes no liability whatsoever, and disclaims any express or implied warranty, relating to sale and/or use of JGD products including liability or warranties relating to fitness for a particular purpose, merchantability, or infringement of any patent, copyright, or other intellectual property right.

The products shown herein are not designed for use in medical, life-saving, or life-sustaining applications. Customers using or selling these products for use in such applications do so at their own risk and agree to fully indemnify JGD for any damages resulting from such improper use or sale.