

CR16UD-02FP
CR16UD-04FP
CR16UD-08FP

DUAL, COMMON CATHODE
ULTRA FAST RECOVERY RECTIFIERS
16 AMP, 200 THRU 800 VOLT



TO-220FP CASE



www.centralemi.com

DESCRIPTION:

The CENTRAL SEMICONDUCTOR CR16UD-02FP series devices are dual, ultra fast recovery silicon rectifiers designed for ultra fast switching applications requiring a low forward voltage drop.

MARKING: FULL PART NUMBER

FEATURES:

- High reliability
- High current capability
- UL flammability classification 94V-O
- Ultra fast recovery time
- Low forward voltage
- High surge capacity
- High voltage

MAXIMUM RATINGS: ($T_C=25^\circ\text{C}$ unless otherwise noted)

| | SYMBOL | CR16UD -02FP | CR16UD -04FP | CR16UD -08FP | UNITS |
|---|----------------|-----------------|-----------------|-----------------|--------------------|
| Peak Repetitive Reverse Voltage | V_{RRM} | 200 | 400 | 800 | V |
| DC Blocking Voltage | V_R | 200 | 400 | 800 | V |
| RMS Reverse Voltage | $V_{R(RMS)}$ | 140 | 280 | 560 | V |
| Average Forward Current ($T_C=100^\circ\text{C}$) | I_O | | 16 | | A |
| Peak Forward Surge Current ($t_p=8.3\text{ms}$) | I_{FSM} | | 125 | | A |
| Operating and Storage Junction Temperature | T_J, T_{stg} | | -65 to +150 | | $^\circ\text{C}$ |
| Typical Thermal Resistance | θ_{JA} | | 30 | | $^\circ\text{C/W}$ |
| Typical Thermal Resistance | θ_{JC} | | 3.0 | | $^\circ\text{C/W}$ |

ELECTRICAL CHARACTERISTICS PER DIODE: ($T_C=25^\circ\text{C}$ unless otherwise noted)

| SYMBOL | TEST CONDITIONS | CR16UD-02FP | | CR16UD-04FP | | CR16UD-08FP | | UNITS |
|----------|---|-------------|-------|-------------|-----|-------------|-----|---------------|
| | | TYP | MAX | TYP | MAX | TYP | MAX | |
| I_R | $V_R=\text{Rated } V_{RRM}$ | - | 5.0 | - | 10 | - | 10 | μA |
| I_R | $V_R=\text{Rated } V_{RRM}, T_C=150^\circ\text{C}$ | - | 250 | - | 500 | - | 500 | μA |
| V_F | $I_F=8.0\text{A}$ | - | 1.0 | - | 1.3 | - | 1.7 | V |
| V_F | $I_F=8.0\text{A}, T_C=150^\circ\text{C}$ | - | 0.895 | - | 1.1 | - | 1.2 | V |
| t_{rr} | $I_F=0.5\text{A}, I_R=1.0\text{A}, I_{rr}=0.25\text{A}$ | 35 | 50 | 35 | 50 | 95 | 100 | ns |
| C_J | $V_R=4.0\text{V}, f=1.0\text{MHz}$ | 170 | - | 170 | - | 130 | - | pF |

CR16UD-02FP
CR16UD-04FP
CR16UD-08FP

DUAL, COMMON CATHODE
ULTRA FAST RECOVERY RECTIFIERS
16 AMP, 200 THRU 800 VOLT



TO-220FP CASE - MECHANICAL OUTLINE

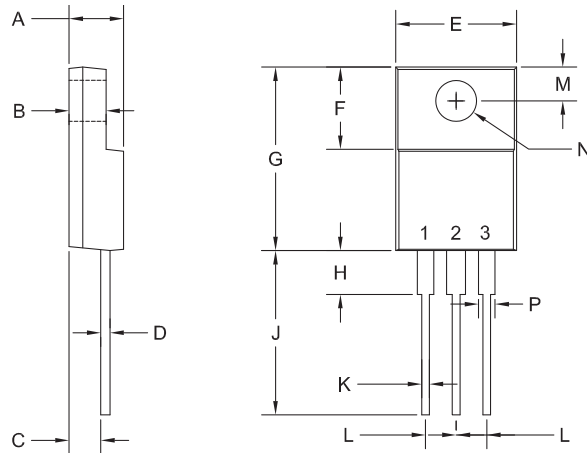

| SYMBOL | INCHES | | MILLIMETERS | |
|---------|--------|-------|-------------|-------|
| | MIN | MAX | MIN | MAX |
| A | 0.165 | 0.202 | 4.20 | 5.12 |
| B | 0.090 | 0.130 | 2.30 | 3.30 |
| C | 0.098 | 0.122 | 2.50 | 3.10 |
| D | - | 0.031 | - | 0.80 |
| E | 0.382 | 0.418 | 9.70 | 10.63 |
| F | 0.238 | 0.276 | 6.06 | 7.00 |
| G | 0.583 | 0.640 | 14.80 | 16.25 |
| H | - | 0.161 | - | 4.10 |
| J | 0.506 | 0.543 | 12.85 | 13.80 |
| K | 0.020 | 0.031 | 0.50 | 0.79 |
| L | 0.100 | | 2.54 | |
| M | 0.120 | 0.140 | 3.05 | 3.55 |
| N (DIA) | 0.116 | 0.134 | 2.95 | 3.40 |
| P | 0.039 | 0.058 | 1.00 | 1.47 |

TO-220FP (REV: R4)

R4

PIN CONFIGURATION

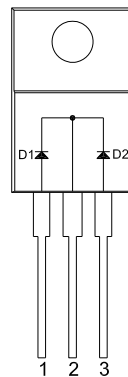

LEAD CODE:

- 1) Anode D1
- 2) Cathode D1, D2
- 3) Anode D2

MARKING:

FULL PART NUMBER

R4 (20-May 2015)

CR16UD-02FP
CR16UD-04FP
CR16UD-08FP

DUAL, COMMON CATHODE
ULTRA FAST RECOVERY RECTIFIERS
16 AMP, 200 THRU 800 VOLT



SERVICES

- Bonded Inventory
- Custom Electrical Screening
- Custom Electrical Characteristic Curves
- SPICE Models
- Custom Packaging
- Package Base Options
- Custom Device Development/ Multi Discrete Modules (MDM™)
- Bare Die Available for Hybrid Applications

LIMITATIONS AND DAMAGES DISCLAIMER: In no event shall Central be liable for any collateral, indirect, punitive, incidental, consequential, or exemplary damages in connection with or arising out of a purchase order or contract or the use of products provided hereunder, regardless of whether Central has been advised of the possibility of such damages. Excluded damages shall include, but not be restricted to: cost of removal or reinstallation, rework, ancillary costs to the procurement of substitute products, loss of profits, loss of savings, loss of use, loss of data, or business interruption. No claim, suit, or action shall be brought against Central more than two (2) years after the related cause of action has occurred.

In no event shall Central's aggregate liability from any warranty, indemnity, or other obligation arising out of or in connection with a purchase order or contract, or any use of any Central product provided hereunder, exceed the total amount paid to Central for the specific products sold under a purchase order or contract with respect to which losses or damages are claimed. The existence of more than one (1) claim against the specific products sold to Buyer under a purchase order or contract shall not enlarge or extend this limit.

Buyer understands and agrees that the foregoing liability limitations are essential elements of a purchase order or contract and that in the absence of such limitations, the material and economic terms of the purchase order or contract would be substantially different.

R4 (20-May 2015)