

2SC930

www.DataSheet4U.com

T-31-15
T-31-17

2033

2003A

NPN Epitaxial Planar
Silicon Transistor

AM Converter, FM RF · IF Amp Applications

©545E

The 2SC930 has two types of package: SPA and NP.

Use

- FM RF amp, mixer, OSC, converter, and IF amplifier.

Absolute Maximum Ratings at $T_a=25^\circ\text{C}$

	2SC930SPA	2SC930NP	unit
Collector to Base Voltage	V_{CB0} 30	30	V
Collector to Emitter Voltage	V_{CE0} 20	20	V
Emitter to Base Voltage	V_{EB0} 5	5	V
Collector Current	I_C 30	30	mA
Collector Dissipation	P_C 120	250	mW
Junction Temperature	T_j 125	125	$^\circ\text{C}$
Storage Temperature	T_{stg} -40 to +125	-55 to +125	$^\circ\text{C}$

Electrical Characteristics at $T_a=25^\circ\text{C}$

		min	typ	max	unit
Collector Cutoff Current	I_{CBO}			1	μA
Emitter Cutoff Current	I_{EBO}			1	μA
DC Current Gain	h_{FE}		40*	320*	
Gain Bandwidth Product	f_T		170	300	MHz
Reverse Transfer capacitance	C_{re}		0.8	1.6	pF
				1.3	pF
Base to Collector	$r_{bb'}c_c$		20	36	pS
Time Constant					
Noise Figure	NF		4.0		dB
Turn-on Time	t_{on}		30		ns
Turn-off Time	t_{off}		30		ns

*The 2SC930 is graded as follows by $\text{mA } h_{FE}$:

40	C	80	60	D	120	100	E	200	160	F	320
----	---	----	----	---	-----	-----	---	-----	-----	---	-----

Case Outline 2033
(unit:mm)

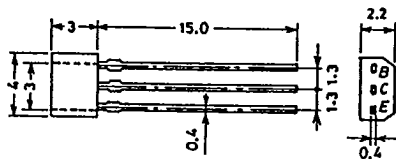

B: Base
C: Collector
E: Emitter

SANYO: SPA

Case Outline 2003A
(unit:mm)

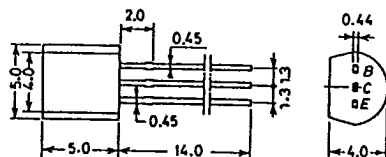

JEDEC: TO-92
EIAJ: SC-43
SANYO: NP

B: Base
C: Collector
E: Emitter

The 2SC930 is scheduled to be discontinued soon. Use the 2SC2839, instead of the 2SC930, in new applications where you are planning to use the 2SC930.

www.DataSheet4U.com

CASE OUTLINES AND ATTACHMENTS

www.DataSheet4U.com

- All of Sanyo Transistor case outlines are illustrated below.
- All dimensions are in mm, and dimensions which are not followed by min. or max. are represented by typical values.
- No marking is indicated.

Case Outline—[2003A]

unit:mm

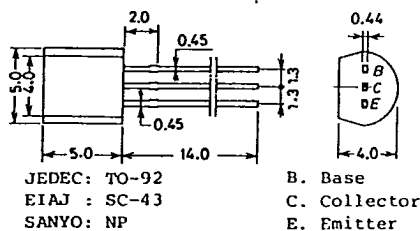

Case Outline—[2009A]

unit:mm

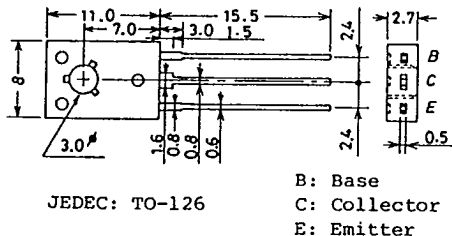

Case Outline—[2004A]

unit:mm

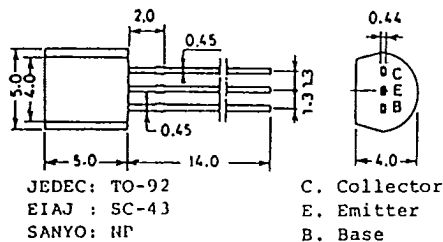

Case Outline—[2010A]

unit:mm

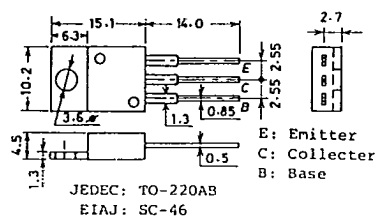

Case Outline—[2005A]

unit:mm

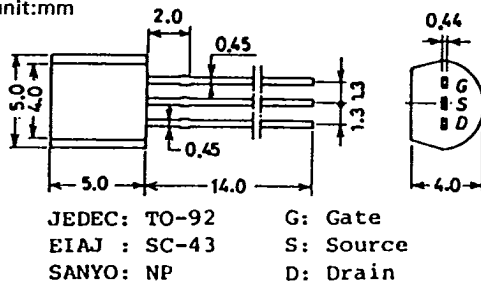

Case Outline—[2012]

unit:mm

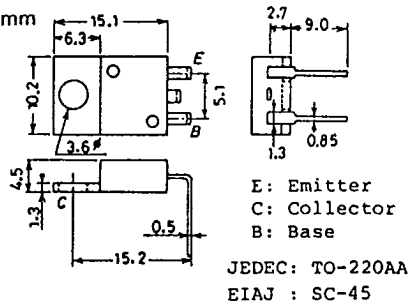

Case Outline—[2006A]

unit:mm

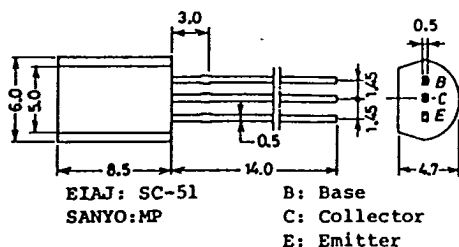

Case Outline—[2013]

unit:mm

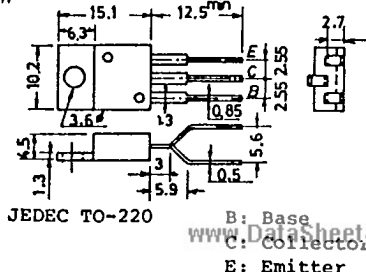

SANYO: DP6B

E: Emitter
C: Collector
B: Base

SANYO: PCP

G1: Catw1
\$: Source
D-r Drain
G2: Gato?
SAYO: On

mm

22.0 20.4 1.0 3.4 8.0 5.0 16.0 21.0 4.0 2.8 2.0 3.5 5.5 8 3.5

E: Emitter
C: Collector
B: Base

SANYO TO3PML

B: Base
C: Collector
E: Emitter
SANYO: SPA

Figure 1 shows the dimensions of the Sanyo SPA device. The diagram includes a cross-sectional view of the device with the following dimensions:

- Gate width: 3
- Channel length: 15.0
- Source/Drain width: 2.2
- Source/Drain height: 0.4
- Gate height: 1.3
- Channel height: 1.3

Legend:

- G: Gate
- S: Source
- D: Drain

SANYO: SPA

D: Drain
G: Gate
S: Source
SANYO: SPA

The drawing shows the mechanical specifications for the SANYO TO22 package. It includes three views: a top view, a side view, and a detail view of the lead spacing.

Top View Dimensions:

- Overall width: 16.0 mm
- Distance from left edge to mounting hole center: 3.5 mm
- Mounting hole diameter: 3.2 mm
- Distance from mounting hole center to lead center: 5.6 mm
- Distance from lead center to right edge: 14.0 mm
- Lead thickness: 0.75 mm
- Lead pitch (distance between leads): 1.6 mm
- Distance from lead center to base: 1.2 mm
- Overall length: 10.0 mm
- Distance from left edge to base: 10.1 mm

Side View Dimensions:

- Overall height: 7.2 mm
- Base thickness: 4.5 mm
- Lead height: 0.7 mm
- Distance from base to mounting hole center: 2.8 mm

Lead Spacing Detail View:

- Lead thickness: 2.4 mm
- Lead pitch: 2.55 mm
- Lead width: 2.55 mm

Legend:

- E: Emitter
- C: Collector
- B: Base

Manufacturer: SANYO: TO22

D: Drain
G: Gate
S: Source
SANYO: SP'

Technical drawing of a transistor package showing top, side, and detail views with dimensions in millimeters.

Top View Dimensions:

- Overall width: 11.0
- Overall length: 15.3
- Pin spacing (left): 1.4
- Pin spacing (right): 3.0
- Pin diameter: 1.5
- Mounting hole diameter: 3.0
- Mounting hole offset: 7.5
- Mounting hole diameter: 4.0
- Mounting hole offset: 8.0
- Mounting hole offset: 1.0
- Mounting hole offset: 1.6
- Mounting hole offset: 0.8
- Mounting hole offset: 0.75

Side View Dimensions:

- Pin height: 1.7
- Pin width: 4.8
- Pin width: 2.4

Detail View Dimensions:

- Pin diameter: 0.7
- Pin length: 3.3

Legend:

- B: Base
- C: Collector
- E: Emitter

Case Outline—[2043A] unit:mm

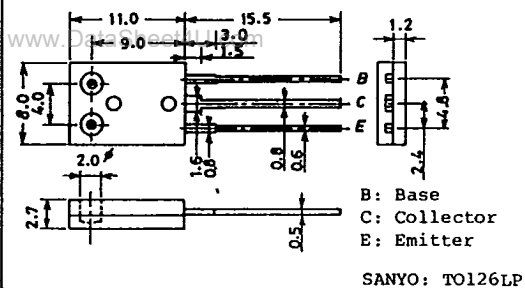

Case Outline—[2050]
unit:mm

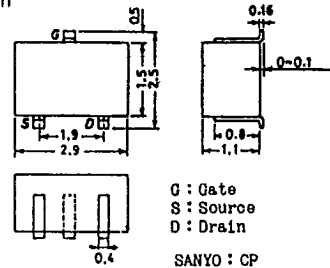

Case Outline—[2045]
unit:mm

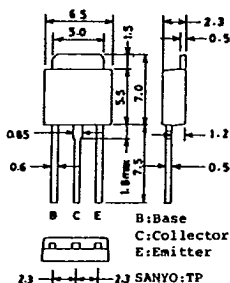

Case Outline—[2051]
unit:mm

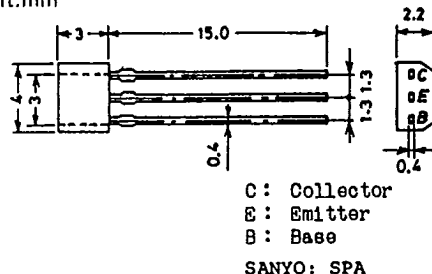

Case Outline—[2046]
unit:mm

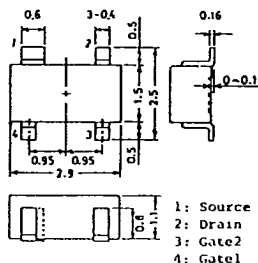

Case Outline—[2052A]
unit:mm

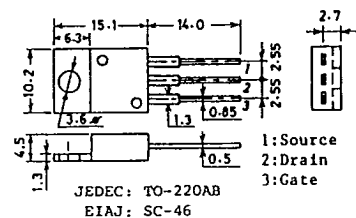

Case Outline—[2048] unit:mm

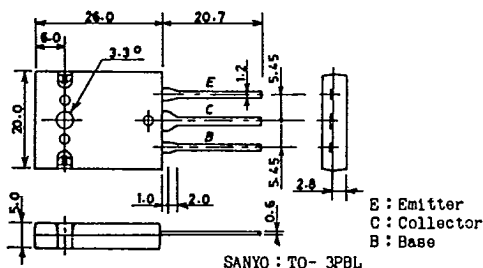

Case Outline—[2053]
unit:mm

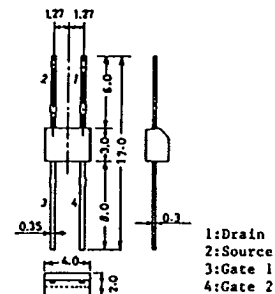

Case Outline—[2049]
unit:mm

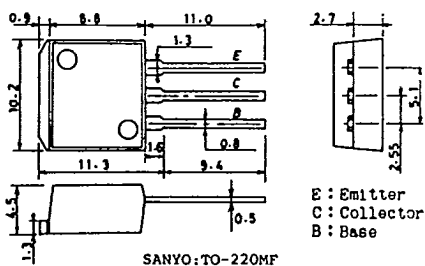

Case Outline—[2054]
unit:mm

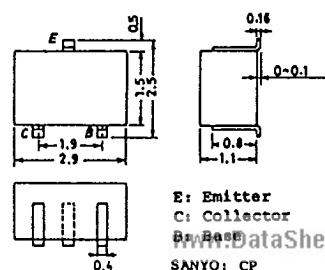

Case Outline—[2056] unit:mm

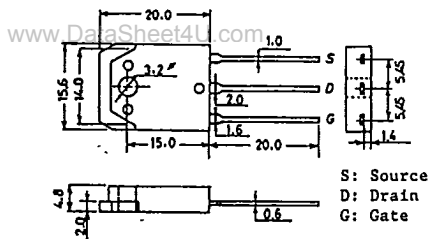

SANYO: TO3PB

Case Outline—[0008]

unit:mm

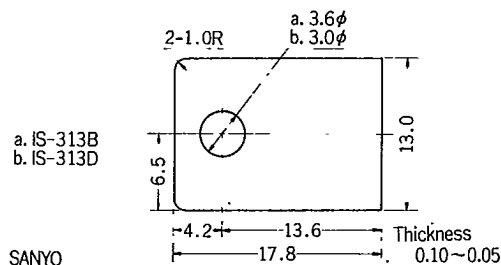

SANYO

Case Outline—[0004]

unit:mm

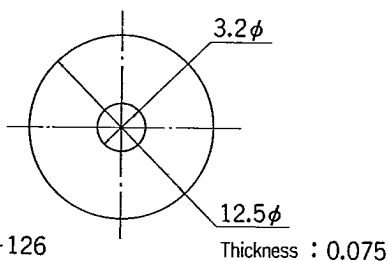

SANYO IS-126

Thickness : 0.075

Case Outline—[0009]

unit:mm

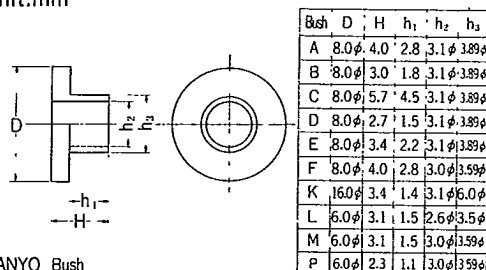

SANYO Bush

Case Outline—[0005]

unit:mm

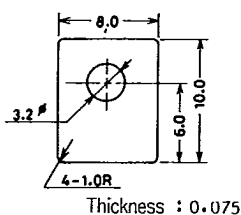

SANYO IS-126A Mica

Case Outline—[0010]

unit:mm

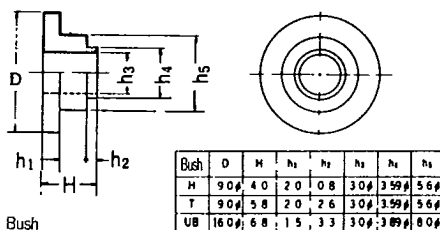

SANYO Bush

Case Outline—[0006]

unit:mm

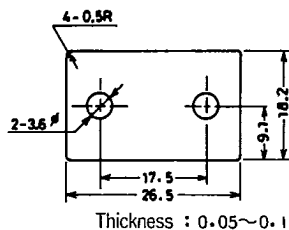

SANYO IS-20MA Mica

Case Outline—[0011]

unit:mm

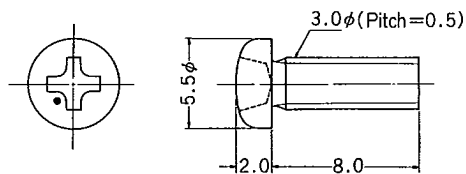

JIS No. B1111 M3×0.5

Case Outline—[0007]

unit:mm

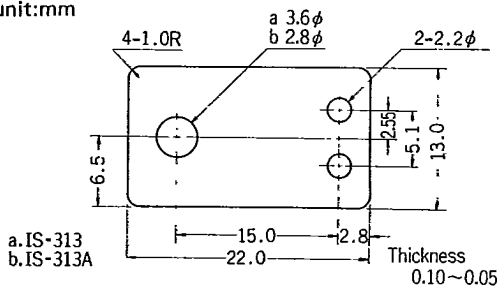

a. IS-313
b. IS-313A

Case Outline—[0012]

unit:mm

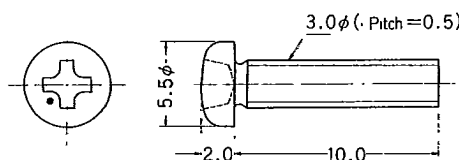

JIS No. B1111 M3×0.5

www.DataSheet4U.com

Case Outline—[0013]

unit:mm

www.DataSheet4U.com

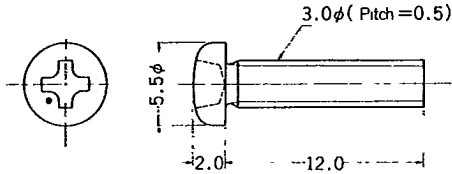

JIS No. B1111 M3x0.5

Case Outline—[0018]

unit:mm

T=91-20

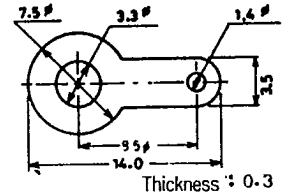

SANYO Lug 1.4

Case Outline—[0014]

unit:mm

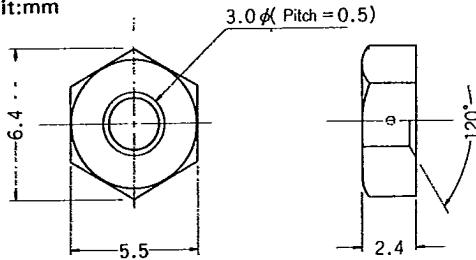

JIS No. B1181 M3x0.5

Case Outline—[0019]

unit:mm

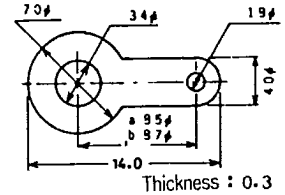

SANYO Lug 1.8φ

Case Outline—[0015]

unit:mm

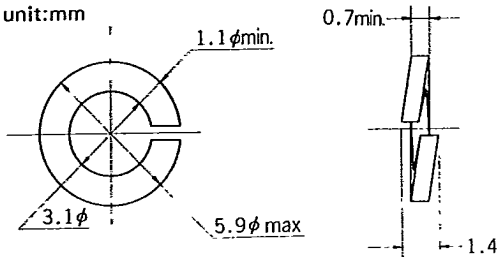

JIS No. B 1251 Spring washer (M3)

Case Outline—[0020]

unit:mm

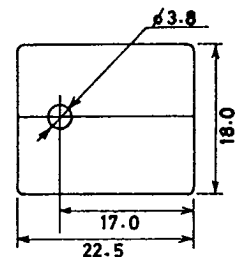

SANYO IS-3MP Mica

Case Outline—[0016]

unit:mm

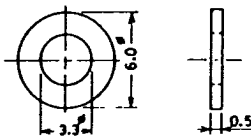

JIS No. B1252 Flat washer

Case Outline—[0021]

unit:mm

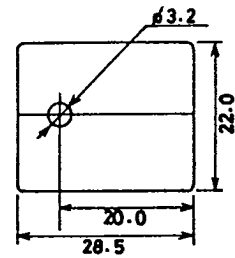

SANYO IS-MPC Mica

Case Outline—[0017]

unit:mm

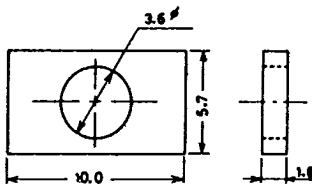

JIS No. G3141 Rectangular washer

Case Outline—[0022]

unit:mm

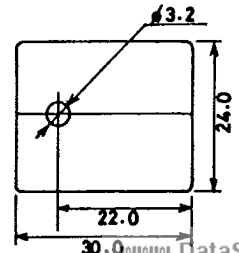

SANYO IS-3PBL Mica

www.DataSheet4U.com