



ANALOG MONITORING RELAY PHASE SEQUENCE
MONITORING 3X 360 TO 520V AC 50 TO 60 HZ 2
CHANGEOVER CONTACTS SCREW TERMINAL
REPLACEMENT PRODUCT FOR 3UG3511-1BQ50

Product function		Phase monitoring relay
Measuring circuit:		
Type of current / for monitoring		AC
Number of poles / for main current circuit		3
Measurable voltage		
• for AC	V	320 ... 500
General technical details:		
Type of display / LED		Yes
Product function		
• undervoltage recognition		No
• overvoltage recognition		No
• phase sequence recognition		Yes
• phase disturbance recognition		No
• asymmetry recognition		No
• overvoltage recognition of 3 phases		No
• undervoltage recognition of 3 phases		No
• tension window recognition of 3 phases		No
• self-reset		Yes
• open-circuit or closed-circuit current principle		No
Starting time / after the control supply voltage has been applied	ms	200

Response time / maximum	ms	450
Voltage type / of control feed voltage		AC
Control supply voltage <ul style="list-style-type: none"> • at 50 Hz / at AC <ul style="list-style-type: none"> • rated value • at 60 Hz / at AC <ul style="list-style-type: none"> • rated value 	V V	320 ... 500 320 ... 500
Operating range factor control supply voltage rated value <ul style="list-style-type: none"> • at 50 Hz <ul style="list-style-type: none"> • for AC • at 60 Hz <ul style="list-style-type: none"> • for AC 		1 ... 1 1 ... 1
Impulse voltage resistance / rated value	kV	6
Recorded real power	W	2
Protection class IP		IP20
Electromagnetic compatibility		IEC 60947-1 / IEC 61000-6-2 / IEC 61000-6-4
Resistance against vibration / according to IEC 60068-2-6		1 ... 6 Hz: 15 mm, 6 ... 500 Hz: 2g
Resistance against shock / according to IEC 60068-2-27		sinusoidal half-wave 15g / 11 ms
Installation altitude / at a height over sea level / maximum	m	2,000
Conductor-bound parasitic coupling BURST / according to IEC 61000-4-4		2 kV
Conductor-bound parasitic coupling conductor-earth SURGE / according to IEC 61000-4-5		2 kV
Conductor-bound parasitic coupling conductor-conductor SURGE / according to IEC 61000-4-5		1 kV
Electrostatic discharge / according to IEC 61000-4-2		6 kV contact discharge / 8 kV air discharge
Field-bound parasitic coupling / according to IEC 61000-4-3		10 V/m
Insulation voltage / for overvoltage category III according to IEC 60664 / with degree of pollution 3 / rated value	V	690
Degree of pollution		3
Ambient temperature <ul style="list-style-type: none"> • during operating • during storage • during transport 	°C °C °C	-25 ... +60 -40 ... +85 -40 ... +85
Galvanic isolation <ul style="list-style-type: none"> • between entrance and outlet • between the outputs • between the voltage supply and other circuits 		Yes Yes Yes
Mechanical design:		
Width	mm	22.5







Height	mm	92
Depth	mm	91
mounting position		any
Distance, to be maintained, to earthed part		
• forwards	mm	0
• backwards	mm	0
• sideways	mm	0
• upwards	mm	0
• downwards	mm	0
Distance, to be maintained, to the ranks assembly		
• forwards	mm	0
• backwards	mm	0
• sideways	mm	0
• upwards	mm	0
• downwards	mm	0
Distance, to be maintained, conductive elements		
• forwards	mm	0
• backwards	mm	0
• sideways	mm	0
• upwards	mm	0
• downwards	mm	0
Mounting type		snap-on mounting
Product function / removable terminal for auxiliary and control circuit		Yes
Design of the electrical connection		screw-type terminals
Type of the connectable conductor cross-sections		
• solid		1x (0.5 ... 4 mm ²), 2x (0.5 ... 2.5 mm ²)
• finely stranded		1x (0.5 ... 2.5 mm ²), 2x (0.5 ... 1.5 mm ²)
• with wire end processing		
• for AWG conductors		
• solid		2x (20 ... 14)
• stranded		2x (20 ... 14)
Tightening torque		
• with screw-type terminals	N·m	0.8 ... 1.2

Outputs:

Number of NO contacts / delayed switching		0
Number of NC contacts / delayed switching		0
Number of change-over switches / delayed switching		2
Current carrying capacity / of output relay		

<ul style="list-style-type: none"> • at AC-15 <ul style="list-style-type: none"> • at 250 V / at 50/60 Hz • at 400 V / at 50/60 Hz • at DC-13 <ul style="list-style-type: none"> • at 24 V • at 125 V • at 250 V 	A	3
	A	3
	A	1
	A	0.2
	A	0.1
Thermal current / of the contact-affected switching element / maximum	A	5
Operating current / at 17 V / minimum	mA	5
Continuous current / of the DIAZED fuse link of the output relay	A	4
Mechanical operating cycles as operating time / typical		10,000,000
Electrical operating cycles as operating time / at AC-15 / at 230 V / typical		100,000
Operating cycles / with 3RT2 contactor / maximum	1/h	5,000

Certificates/approvals:

General Product Approval		EMC	Test Certificates	
			Special Test Certificate	Type Test Certificates/Test Report
CCC	UL	C-TICK		
Shipping Approval			other	
			Declaration of Conformity	other
DNV	GL	LRS		

Further information:

Information- and Downloadcenter (Catalogs, Brochures,...)

<http://www.siemens.com/industrial-controls/catalogs>

Industry Mall (Online ordering system)

<http://www.siemens.com/industrial-controls/mall>

Cax online generator:

<http://www.siemens.com/cax>

Service&Support (Manuals, Certificates, Characteristics, FAQs,...)

<http://support.automation.siemens.com/WW/view/en/3UG4511-1BP20/all>

Image database (product images, 2D dimension drawings, 3D models, device circuit diagrams, ...)

http://www.automation.siemens.com/bilddb/cax_en.aspx?mlfb=3UG4511-1BP20

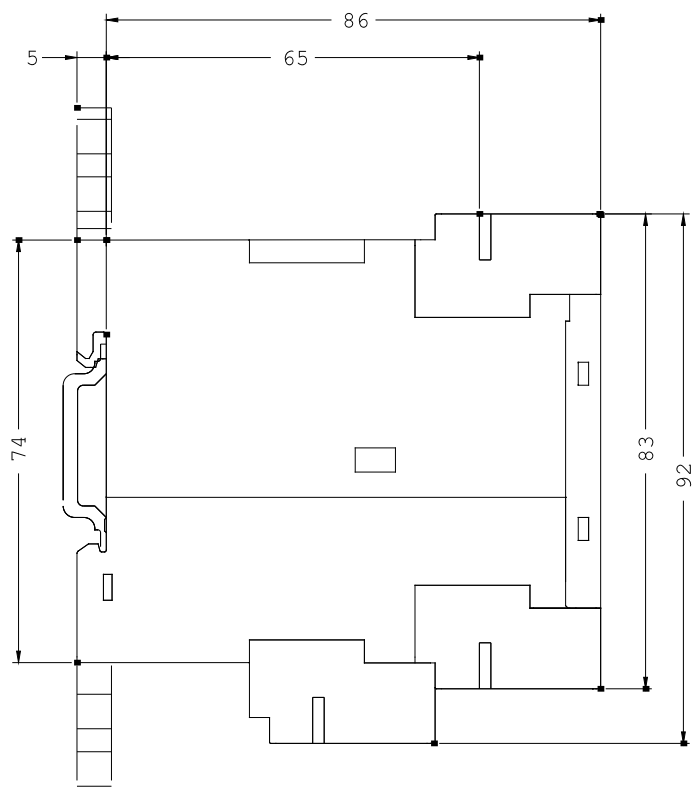

Mar 17, 2014