

### Standard Recovery Diodes (Stud and Flat Base Type)

#### Features

- Diffused Series
- Industrial grade
- Available in Normal and Reverse polarity
- Metric and UNF thread type

| Electrical Specifications ( $T_E = 25^{\circ}\text{C}$ , unless otherwise noted) |  |        |                        |
|--|--|--------|------------------------|
| Symbol   | Parameters   | Values | Units                  |
| $I_{F(AV)}$  | Maximum avg. forward current @ $T_E = 150^{\circ}\text{C}$ | 400    | A                      |
| $V_{FM}$   | Maximum peak forward voltage drop @ rated $I_{F(AV)}$      | 1.4    | V                      |
| $I_{FSM}$  | Maximum peak one cycle (non-rep) surge current @ 10 msec   | 8250   | A                      |
| $I_{FRM}$  | Maximum peak repetitive surge current                      | 16000  | A                      |
| $I^2t$   | Maximum $I^2t$ rating (non-rep) for 5 to 10 msec           | 340000 | $\text{A}^2\text{sec}$ |



DO-205AB (DO-9)

| Electrical Ratings ( $T_E = 25^{\circ}\text{C}$ , unless otherwise noted) |              |   |  |   |                                     |  |
|---|--------------|---|--|---|-------------------------------------|--|
| Type number   | Voltage Code | $V_{RRM}$ , Maximum repetitive peak reverse voltage (V) | $V_{R(RMS)}$ , Maximum RMS reverse voltage (V) | $V_R$ , Maximum DC blocking voltage (V) | Recommended RMS working voltage (V) | $I_{R(AV)}$ , Maximum avg. reverse leakage current ( $\mu\text{A}$ ) |
| 400NS(R)  | 10           | 100   | 70   | 100                                     | 40                                  | 200  |
|   | 20           | 200   | 140  | 200                                     | 80                                  |  |
|   | 40           | 400   | 280  | 400                                     | 160                                 |  |
|   | 60           | 600   | 420  | 600                                     | 240                                 |  |
|   | 80           | 800   | 560  | 800                                     | 320                                 |  |
|   | 100          | 1000  | 700  | 1000                                    | 400                                 |  |
|   | 120          | 1200  | 840  | 1200                                    | 480                                 |  |
|   | 140          | 1400  | 980  | 1400                                    | 560                                 |  |
|   | 160          | 1600  | 1120   | 1600                                    | 640                                 |  |

**Thermal & Mechanical Specifications** ( $T_E = 25^{\circ}\text{C}$ , unless otherwise noted)

| Symbol       | Parameters                                   | Values                | Units                |
|--------------|--|-----------------------|----------------------|
| $R_{th(jc)}$ | Maximum thermal resistance, junction to case | 0.15                  | $^{\circ}\text{C/W}$ |
| $T_J$        | Operating junction temperature range         | -65 to 150            | $^{\circ}\text{C}$   |
| $T_{stg}$    | Storage temperature                          | -65 to 200            | $^{\circ}\text{C}$   |
|              | Mounting torque (non-lubricated threads)     | 3.2 (min) – 3.7 (max) |                      |
| W            | Approximate allowable weight                 | 260                   | G                    |

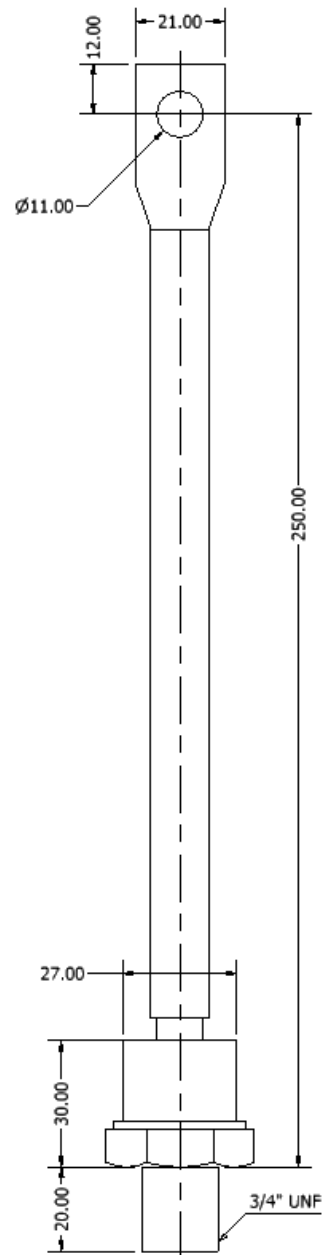
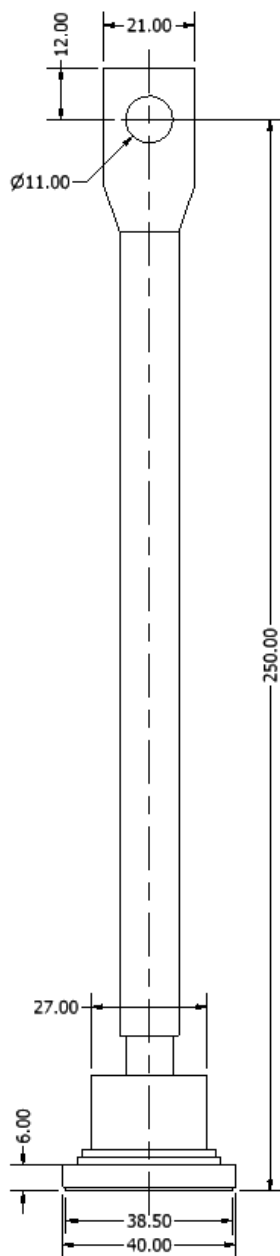

ALL DIMENSIONS IN MM