

Type: S-5CL3

◆ Product Description

- 5.9×5.9mm Max.(L×W), 7.7mm Max. Height.
- Inductance: 30μH Max.
- Operating frequency: 300MHz Max.
- In addition to the reference versions of parameters shown here, custom designs are available to meet your exact requirements.



◆ Feature

- Variable shielded type.
- RoHS Compliance

◆ Dimensions (mm)

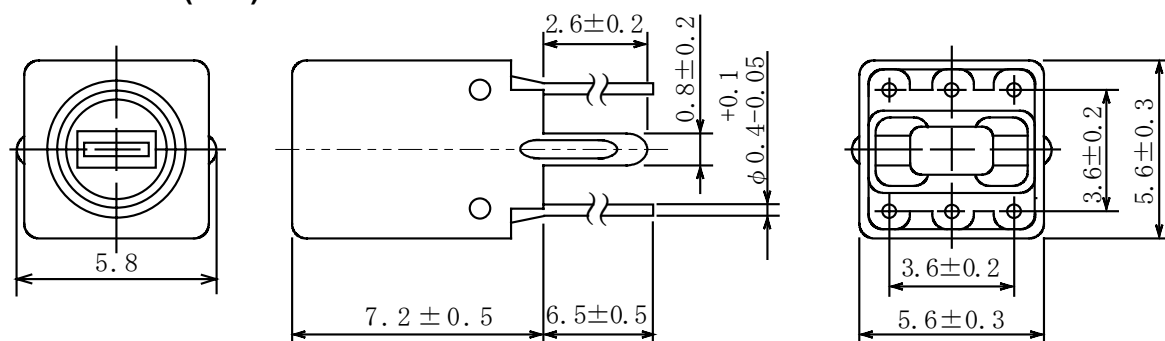

- * Dimension does not include solder used on coil.
- * Pin pitch should be measured at the root of terminal.
- * Dimensions without tolerance are approx.

◆ Connection (Bottom View)

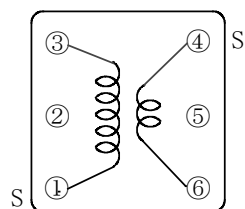

“S” is winding start.

◆ Specification (Part No. 2255-T252)

Item	(1-3)	Measuring Condition
Tuning capacity	20.0pF±3% Variable	30MHz
Unloaded Qu	30 Min.	30MHz