



MOS Controlled Diode

PRODUCT SUMMARY

V _{RRM}	I _O	V _F (MAX) @ 25°C	I _R (MAX) @ 25°C
45V	15A	0.53V	0.5mA

FEATURES

- Low Profile Design for Smart Phone Charger
- Ideal for SMT Mounting
- Low forward voltage drop
- High forward surge capability
- Excellent High Temperature Stability

TO-277



Top View



Bottom View

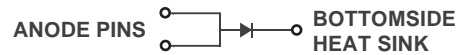

ABSOLUTE MAXIMUM RATINGS (T_A=25°C unless otherwise noted)

Symbol	Parameter	Value	Unit
V _{RRM}	Peak Repetitive Reverse Voltage	45	V
V _{RWM}	Working Peak Reverse Voltage	45	V
V _{RM}	DC Blocking Voltage	45	V
V _{R(RMS)}	RMS Reverse Voltage	32	V
I _O	Average Rectified Output Current	15	A
I _{FSM}	Non-Repetitive Peak Forward Surge Current 8.3ms Single Half Sine-Wave Superimposed on Rated Load	150	A
E _{AS}	Non-Repetitive Avalanche Energy (T _J = 25°C, I _{AS} = 11, L = 5mH)	210	mJ
P _{ARM}	Repetitive Peak Avalanche Energy	26000	W

THERMAL CHARACTERISTICS

Symbol	Parameter	Value	Unit
R _{θJA}	Thermal Resistance, Junction-to-Ambient	70	°C/W
T _J	Operating Temperature Range	-55 to 150	°C
T _{STG}	Storage Temperature Range	-55 to 175	°C

ELECTRICAL CHARACTERISTICS (T_A=25°C unless otherwise specified)

Symbol	Parameter	Conditions	Min	Typ	Max	Unit
V _F	Forward Voltage Drop	I _F = 15A, T _J = 25°C		0.48	0.53	V
		I _F = 15A, T _J = 125°C		0.46	0.52	V
I _R	Leakage Current	V _R = 45V, T _J = 25°C		80	500	uA
		V _R = 45V, T _J = 125°C			100	mA
C _T	Total Capacitance	V _R = 45V, f = 1MHz		200		pF

SMD15V45SP

Ver 1.0

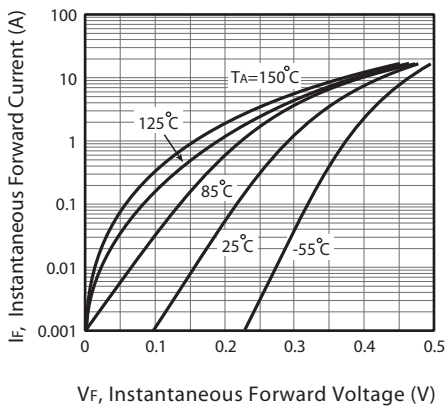

Figure 1. Typical Forward Characteristics

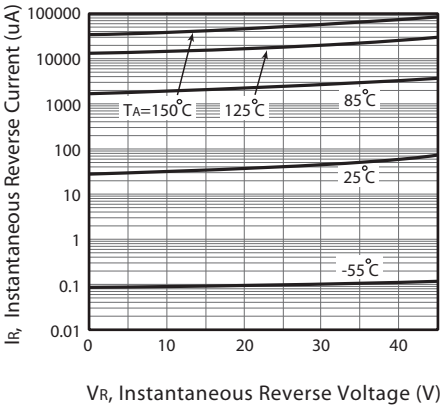

Figure 2. Typical Reverse Characteristics

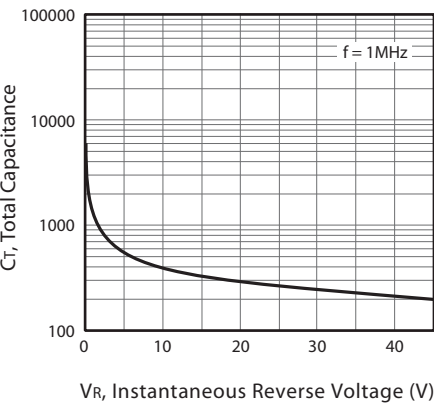

Figure 3. Total Capacitance vs. Reverse Voltage

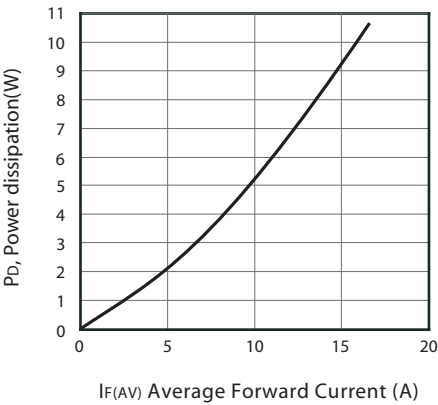

Figure 4. Forward Power Dissipation

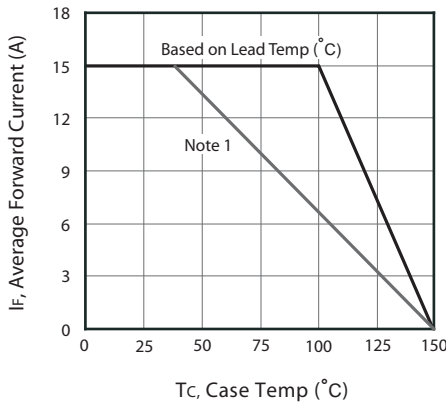

Figure 4. Forward Power Dissipation

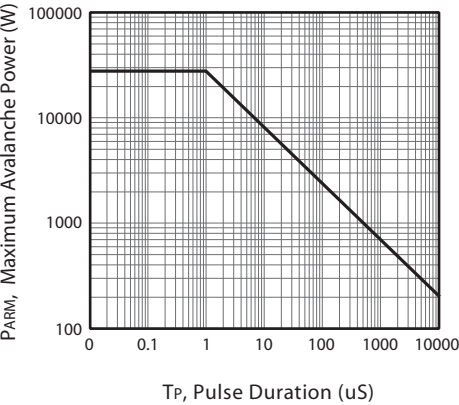

Figure 6. Maximum Avalanche Power Curve

Note : 1.Device mounted on FR-4 substrate, 2oz copper.

Aug,01,2014

SMD15V45SP

Ver 1.0

PACKAGE OUTLINE DIMENSIONS

TO-277

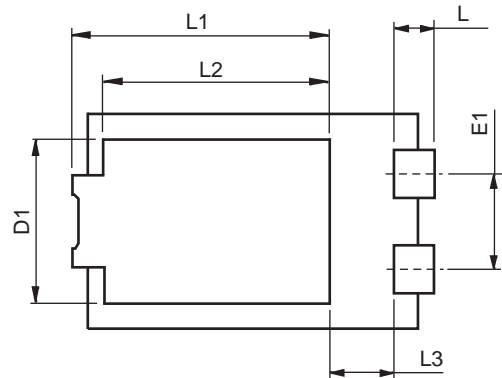
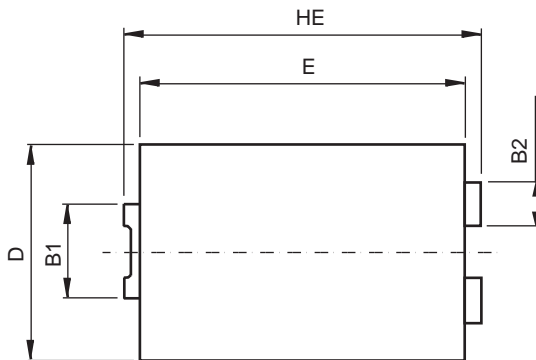

SYMBOLS	MILLIMETERS	
	MIN.	MAX.
HE	6.40	6.60
E	5.60	5.80
D	4.10	4.30
B1	1.70	1.90
B2	0.80	1.00
A	1.05	1.20
C	0.30	0.40
L	0.85	1.10
L1	4.20	4.40
L2	3.52 Typ.	
L3	1.10	1.40
D1	3.00	3.30
E1	1.86 Typ.	

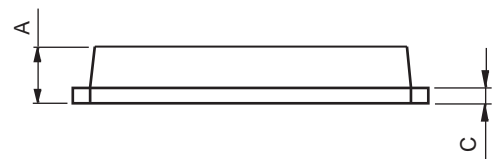

Mounting Pad Layout (unit:mm)

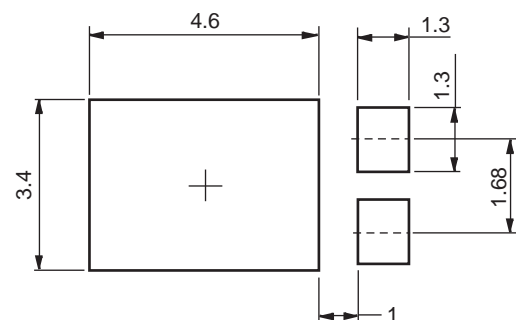

Aug,01,2014

SMD15V45SP

Ver 1.0

TOP MARKING DEFINITION

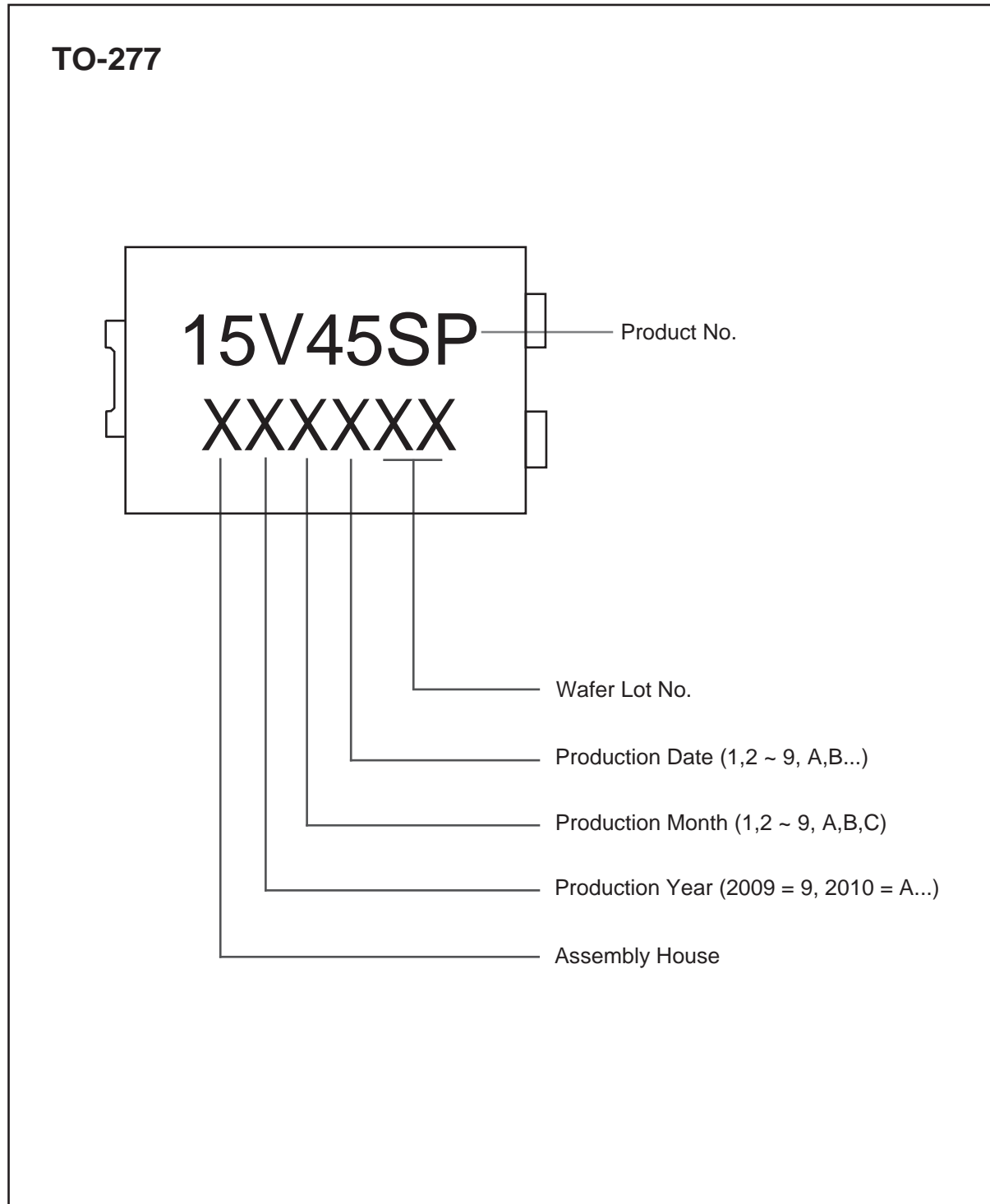

Aug,01,2014